

Zoids

Ref No. 5904 KRARK

KRARK

PRINCE OF DARKNESS

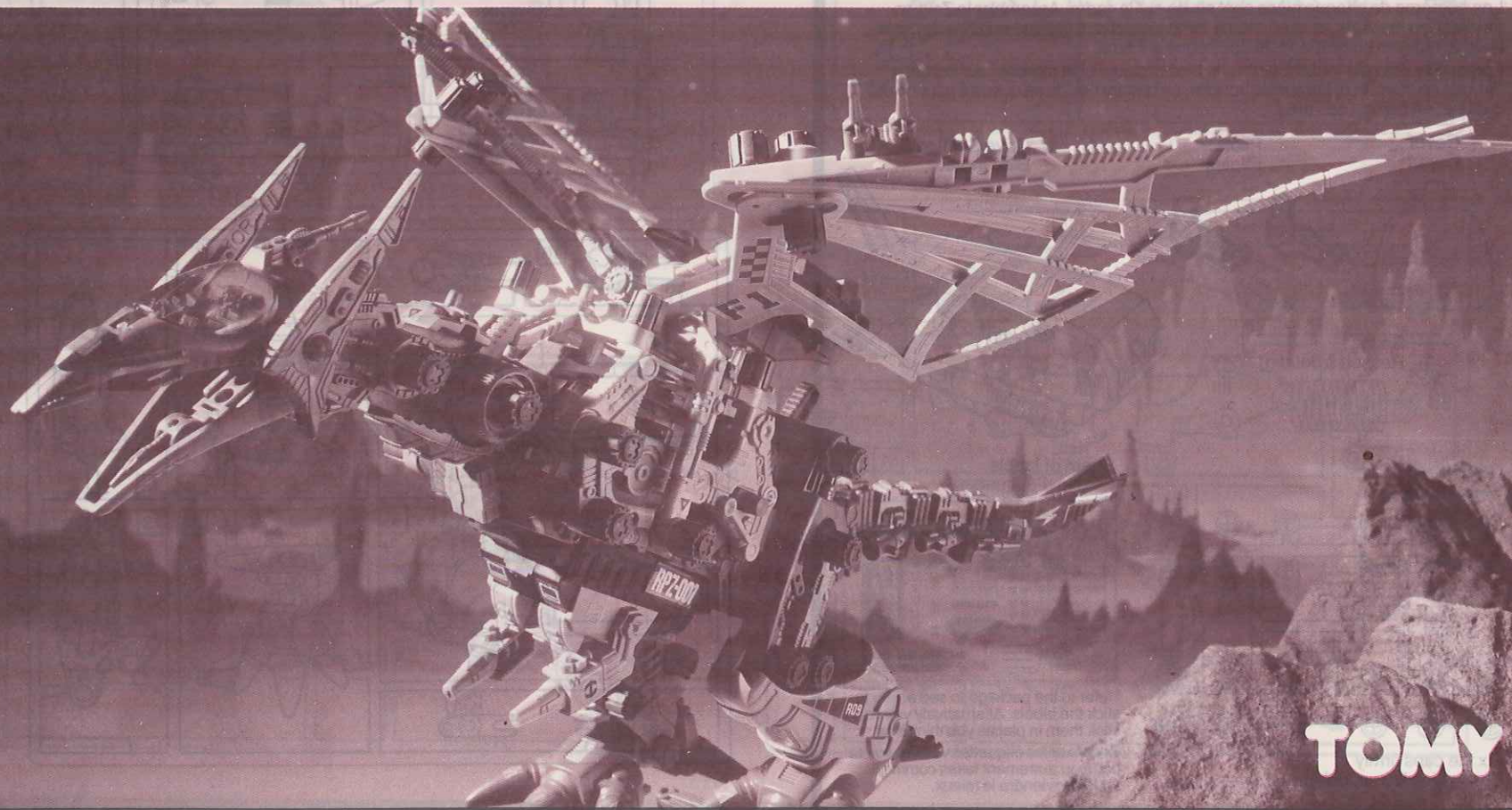

TOMY

Introduction

Please read carefully before assembling.

Separate the parts as they are needed, following the order given in the Instruction Manual.

Numbers are marked on the frame holding the parts. Assemble the Zoid looking carefully at the Assembly Drawings and checking the Part Numbers.

After the Zoid (Krark) has been completed, motor drive can make it walk on two legs while opening and closing its mouth, swishing its tail to left and right and flapping its wings.

Introduction

Avant de commencer. Etudier bien les instructions ci-dessous avant d'assembler.

Séparer les pièces au fur et à mesure, en suivant les instructions du Manuel.

Les numéros de chaque pièce sont situés sur le cadre. Assembler le Zoid en étudiant les illustrations et en même temps identifiant chaque numéro de pièce avec le numéro correspondant de chaque schéma.

Lorsque le Zoid est tout assemblé, le bloc moteur le fait marcher sur les deux jambes en ouvrant et fermant la bouche, en battant l'air de sa queue à gauche et à droite et en battant ses ailes.

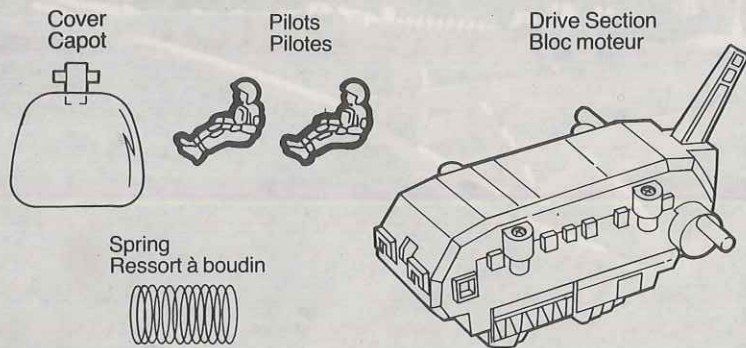

Caps
Capuchons

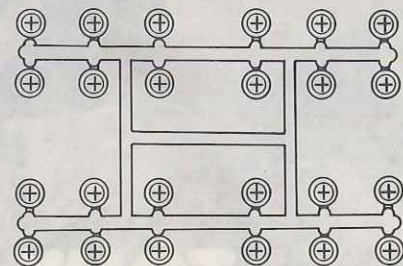

Fix the caps firmly
Serrer bien les capuchons

Sheet of labels
Feuille d'étiquettes



Refer to the package to see where to stick the labels. Alternatively you can stick them in places you think best.
Pour fixer les étiquettes veuillez voir la boîte ou autrement faites comme il vous conviendra le mieux.

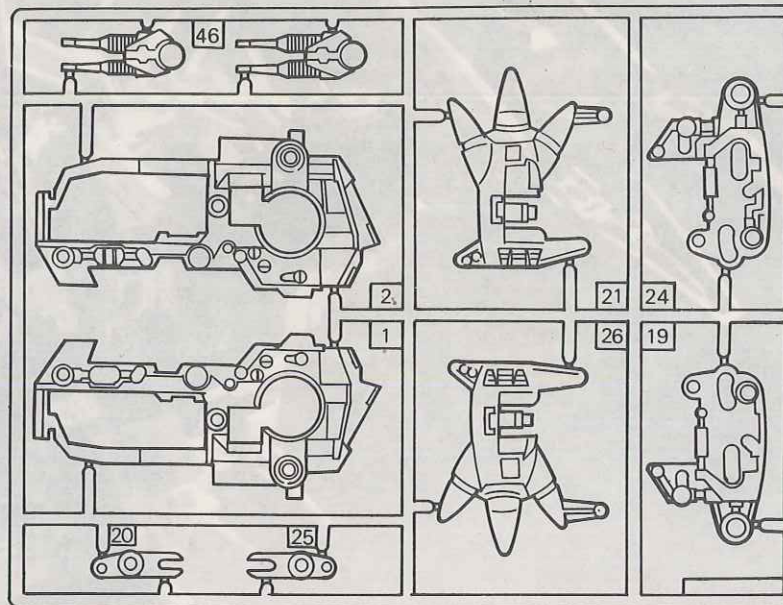
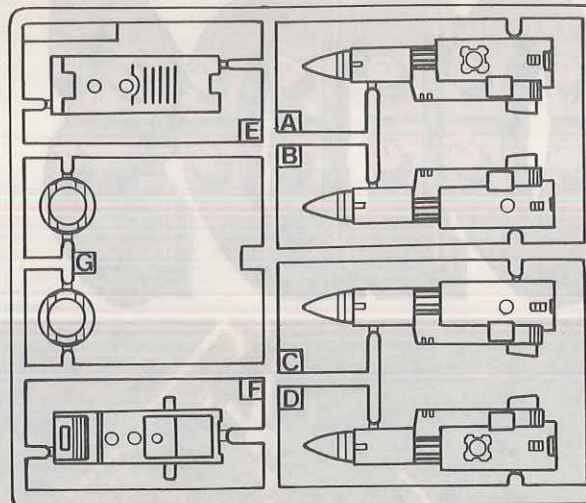

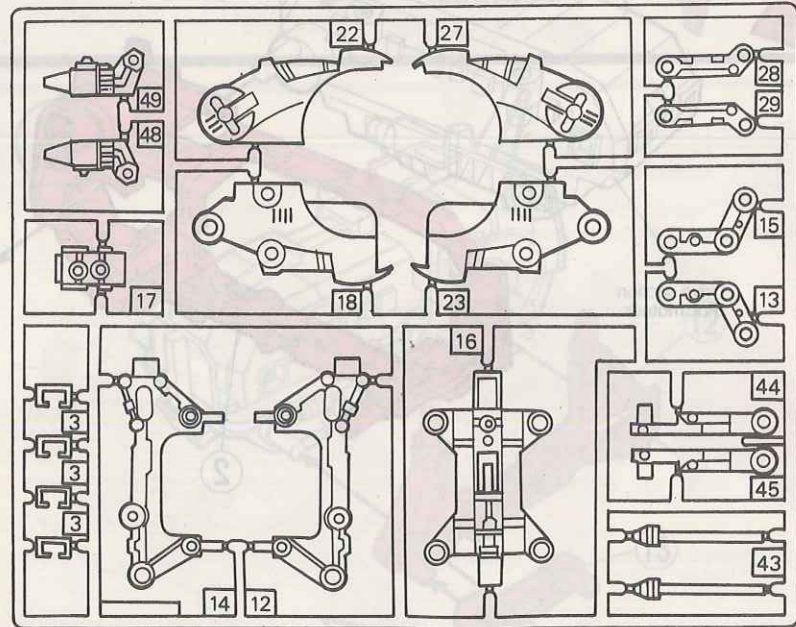
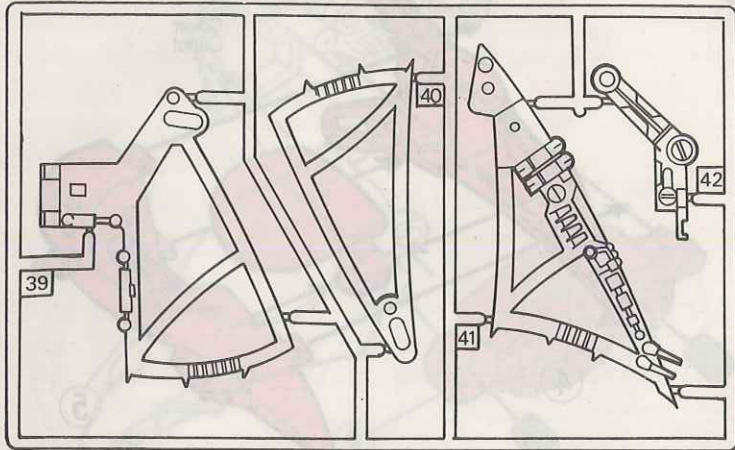
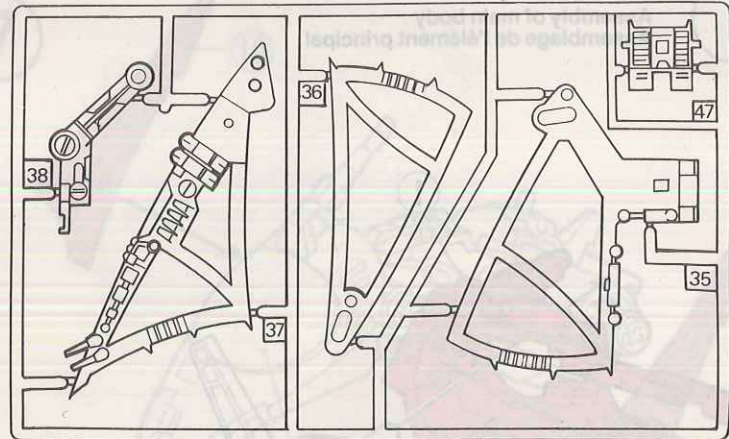
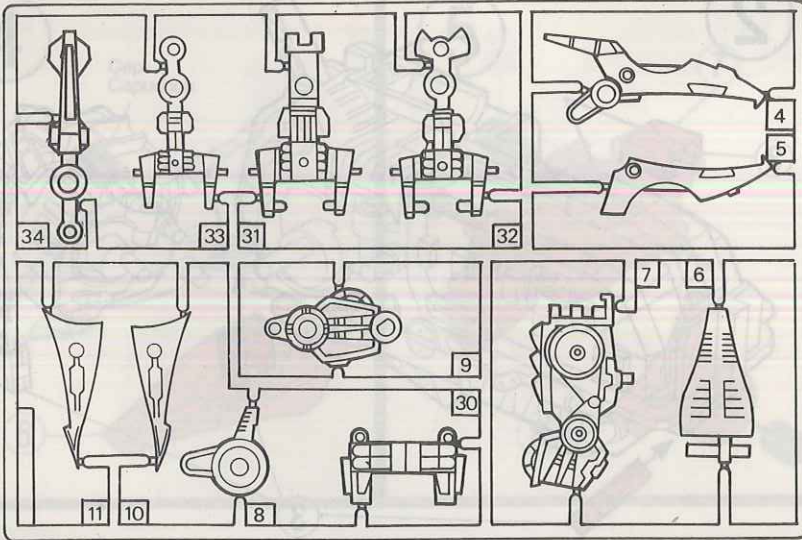

1

Assembly of main body
Assemblage de l'élément principal

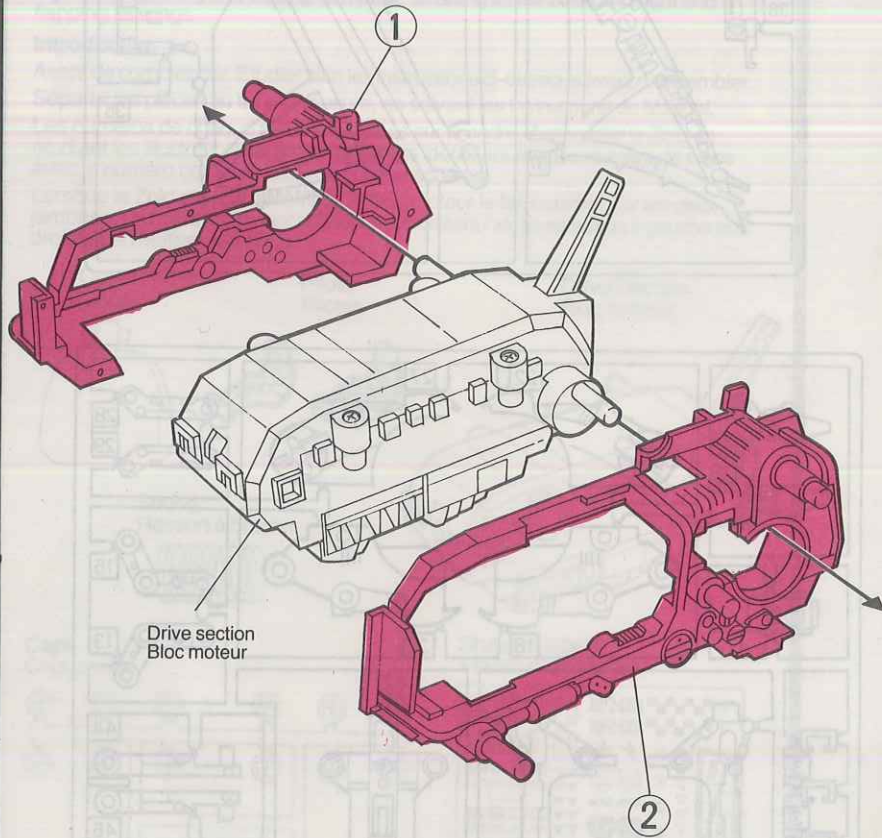

2

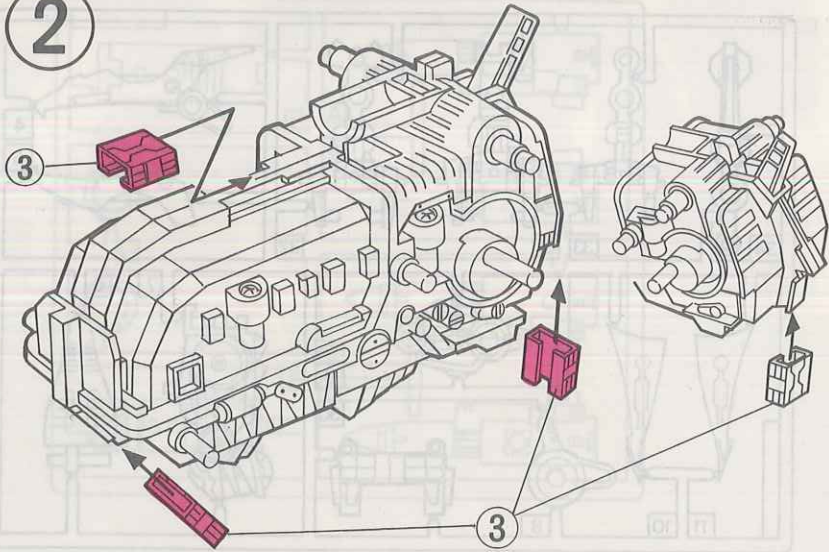

3

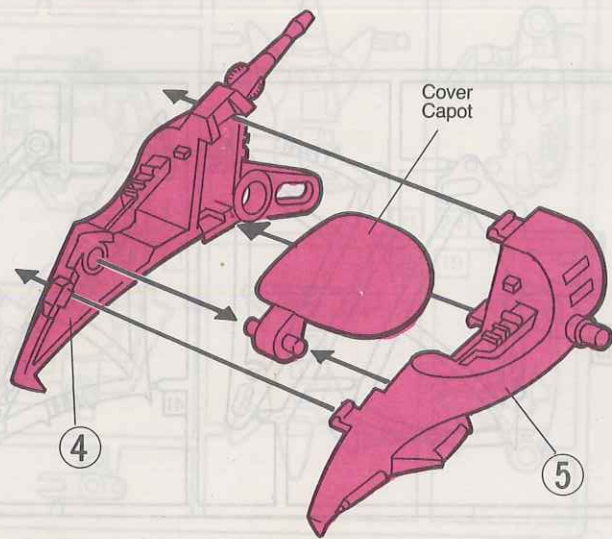

4

Cap
Capuchon

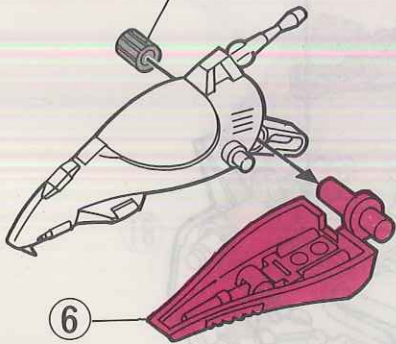

5

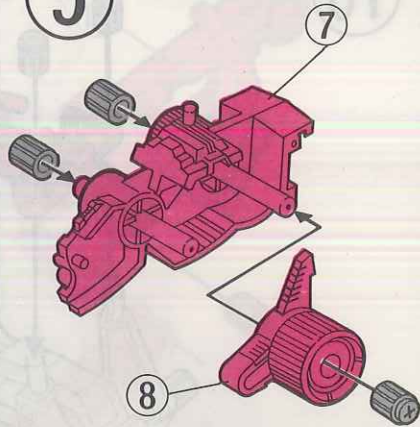

7

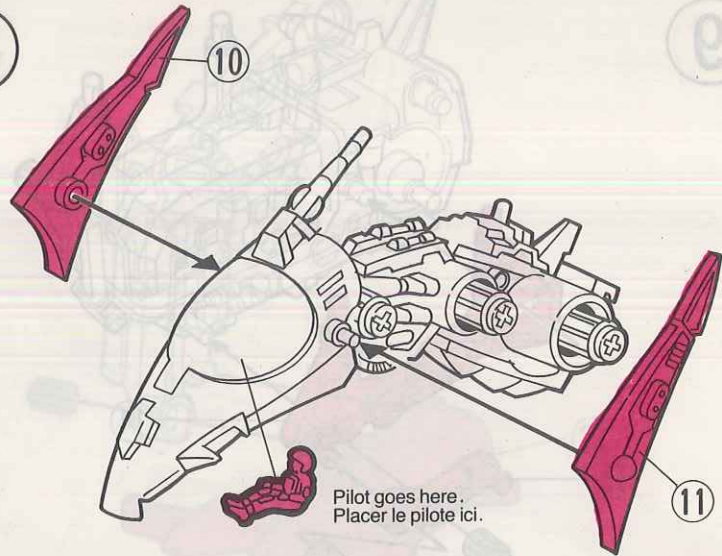

Pilot goes here.
Placer le pilote ici.

6

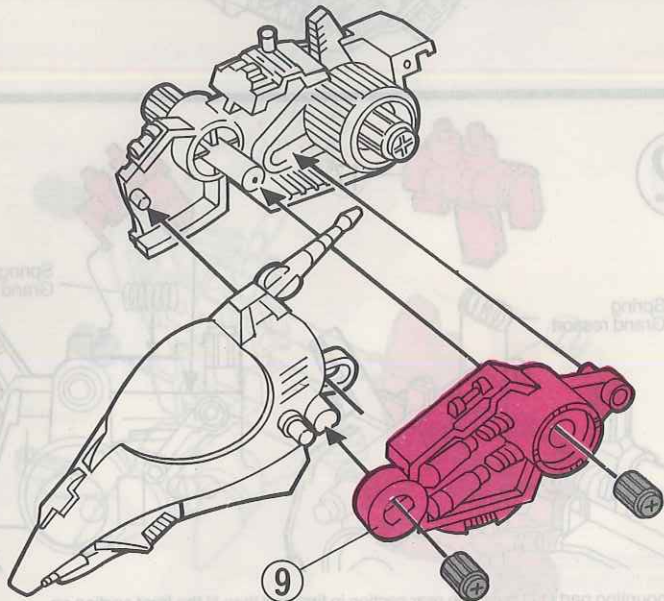

8

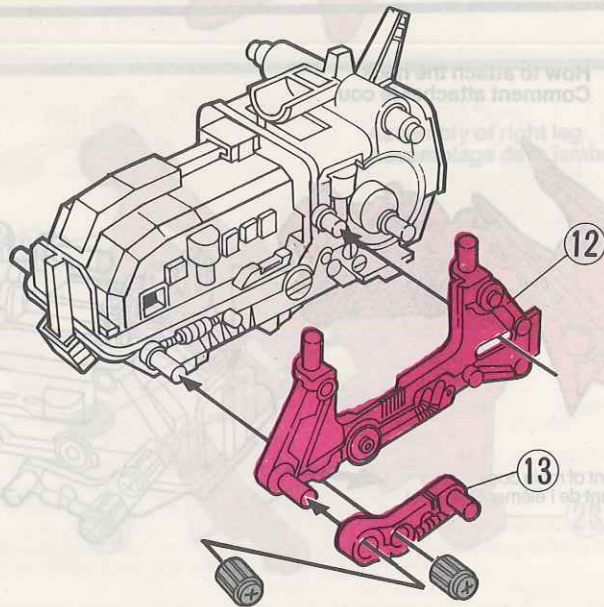

9

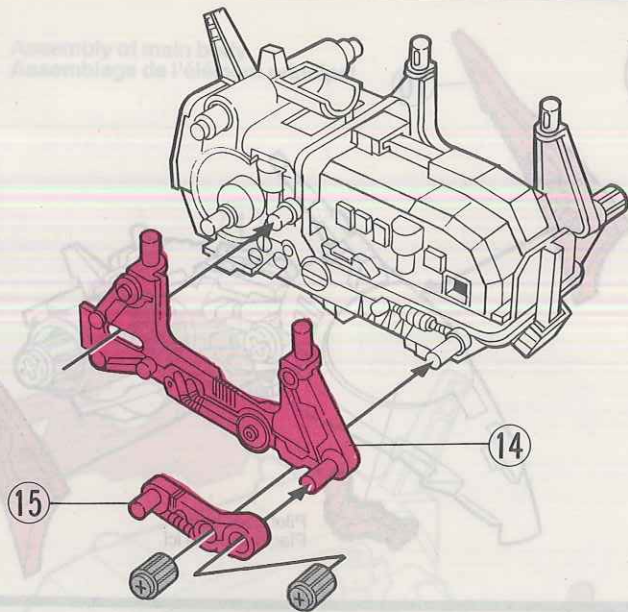

10

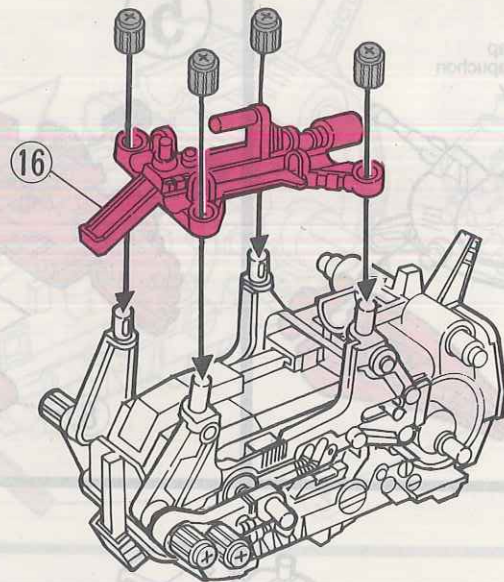

11

How to attach the neck
Comment attacher le cou

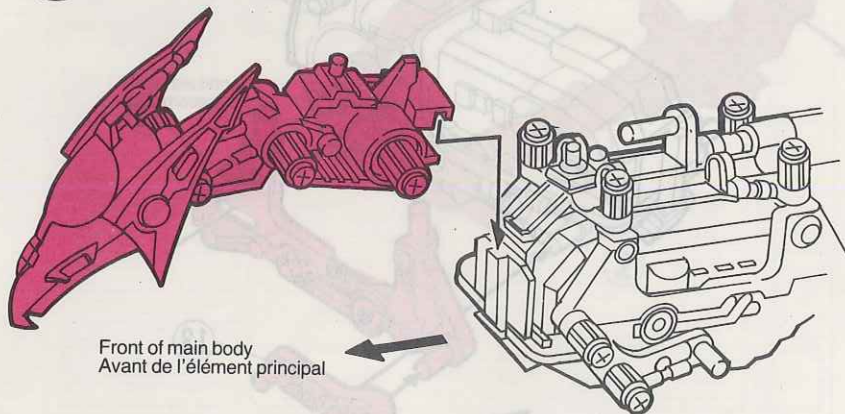

12

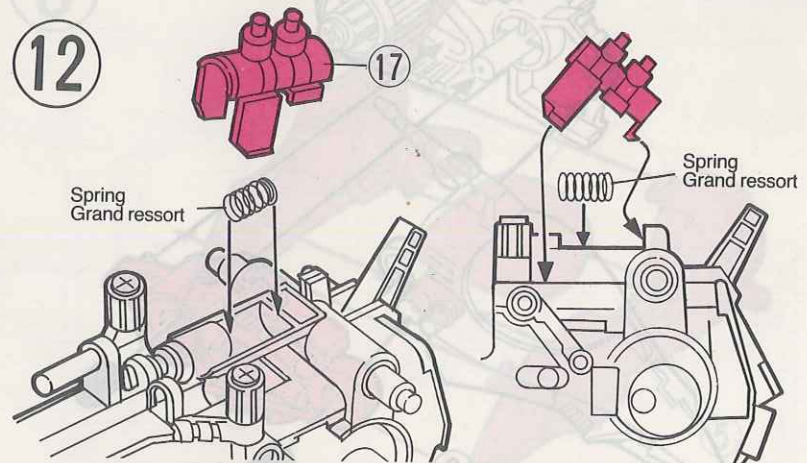

When mounting part (17) push the rear section in first and then fit the front section on.
En montant la pièce (17), ajuster l'élément arrière avant d'assembler l'avant de l'élément.

13

Assembly of left leg
Assemblage de la jambe gauche

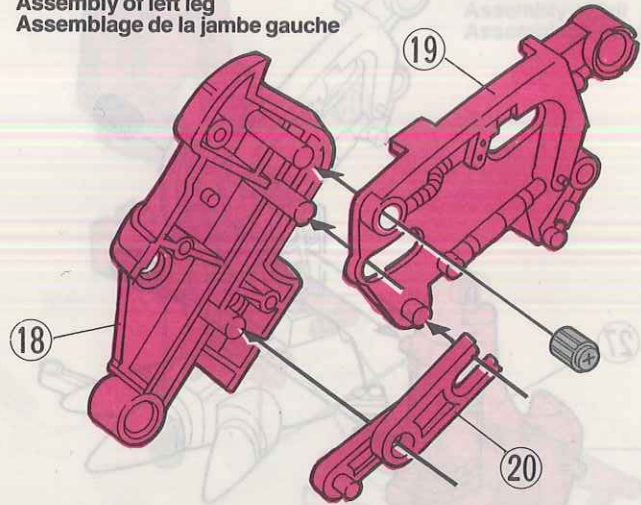

14

How to attach the
Dismounting attachment

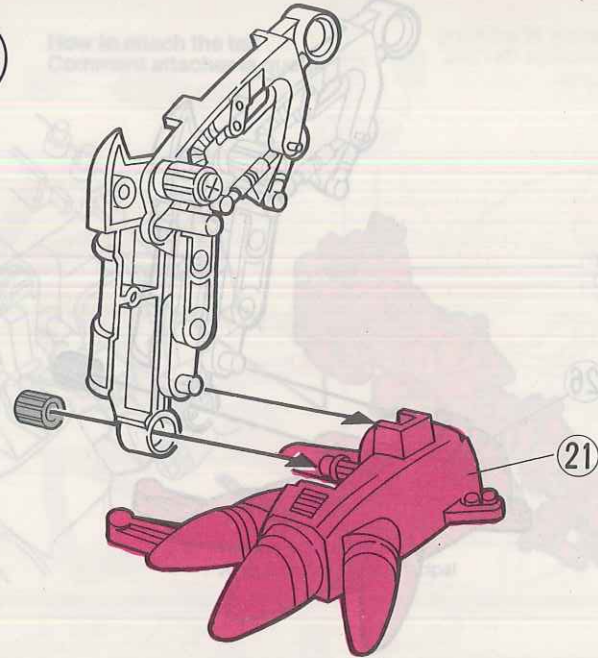

15

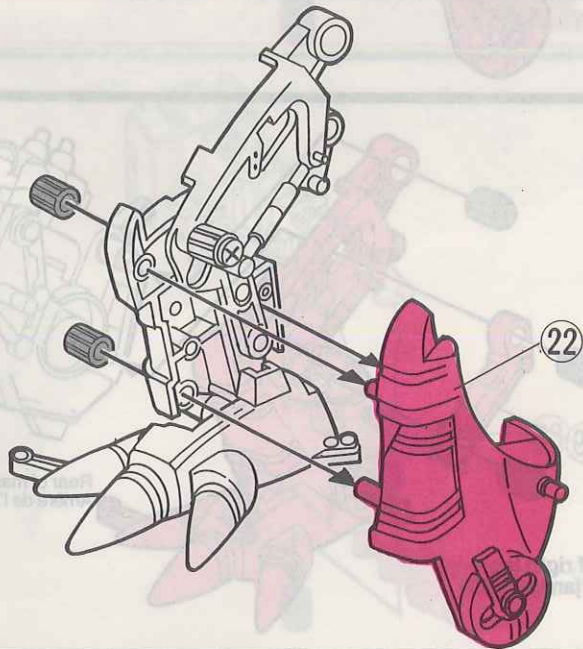

16

Assembly of right leg
Assemblage de la jambe droite

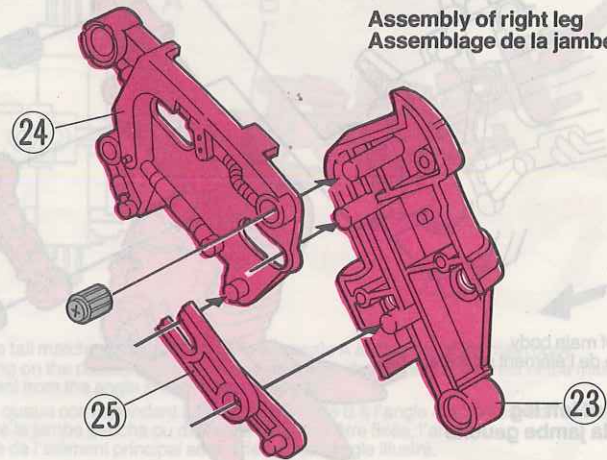

17

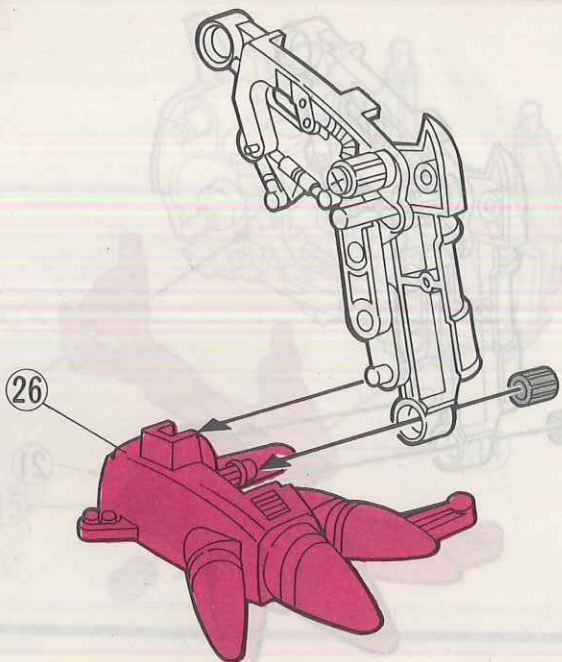

18

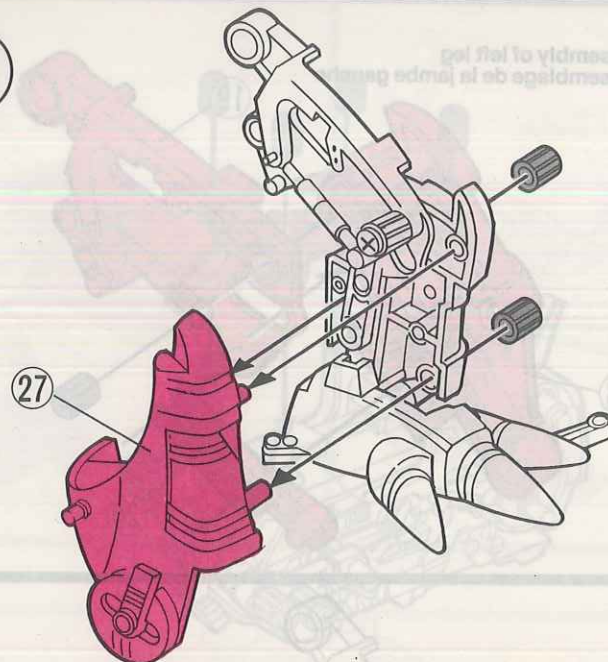

19

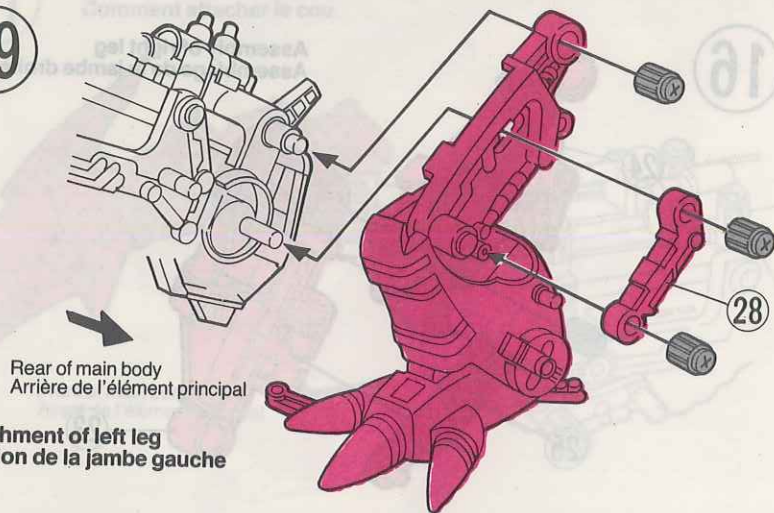

Rear of main body
Arrière de l'élément principal

Attachment of left leg
Fixation de la jambe gauche

20

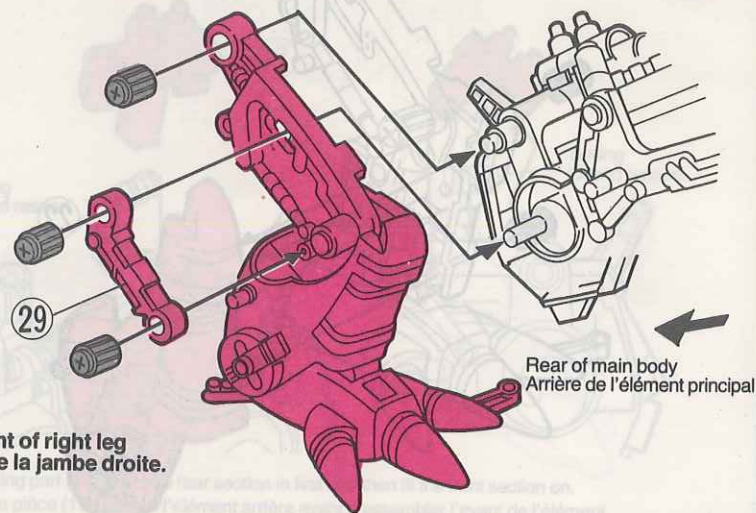

Rear of main body
Arrière de l'élément principal

Attachment of right leg
Fixation de la jambe droite.

21

Assembly of tail
Assemblage de la queue

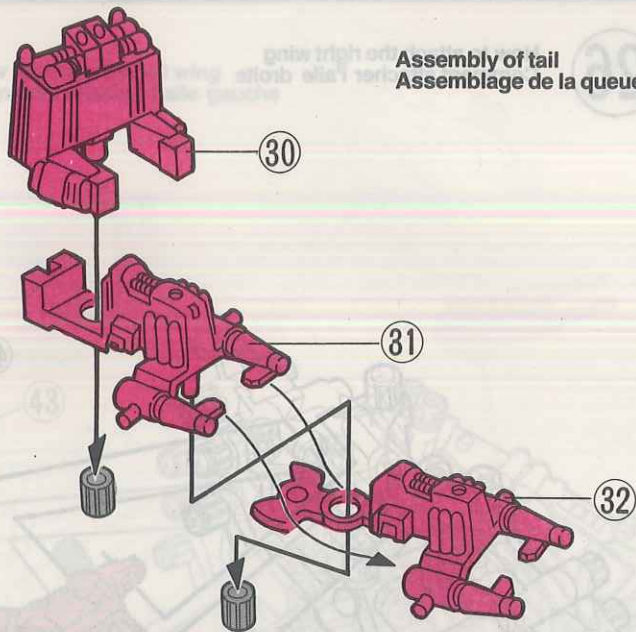

22

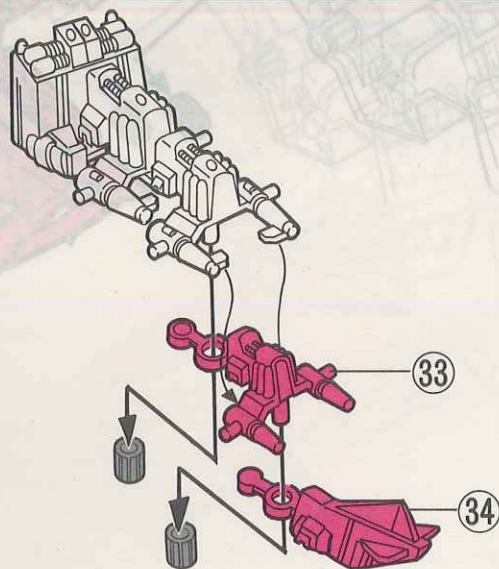

23

How to attach the tail
Comment attacher la queue

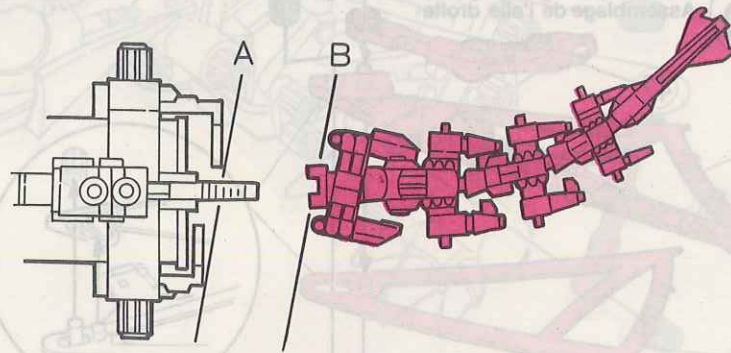
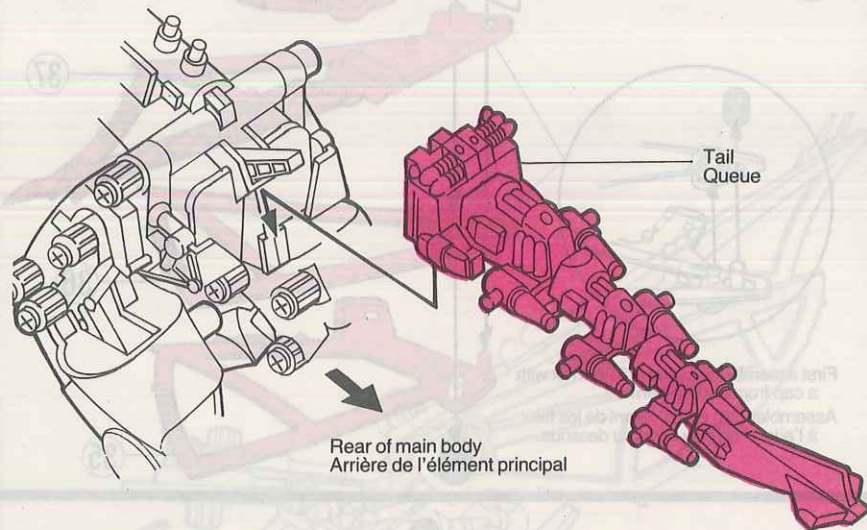

Fix on the tail matching the tail angle B to the angle A at the rear of the main body.
 Depending on the positions of the left and right legs, the angle A at the rear of the main body may be different from the angle shown in the drawing.
 Placer la queue correspondant à l'illustration Angle B à l'angle A à l'arrière de l'élément principal.
 Selon que la jambe gauche ou droite est en train d'être fixée, l'angle A à l'arrière de l'élément principal sera différent de l'angle illustré.

24

Assembly of left wing
Assemblage de l'aile gauche

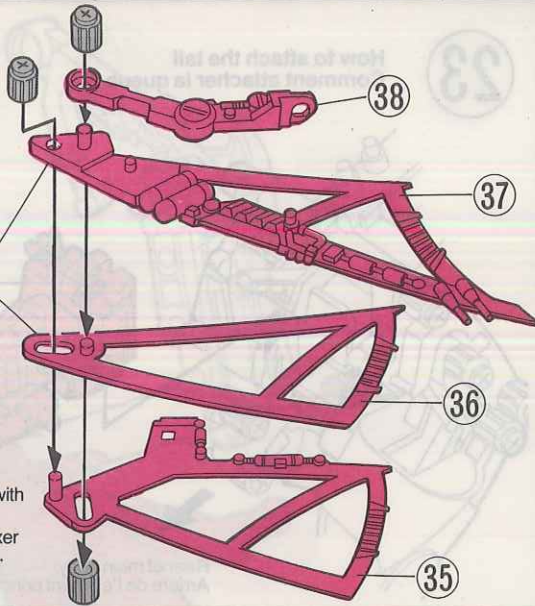
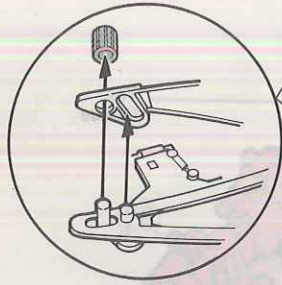

First assemble (35) and (36) then fix with a cap from underneath.
Assembler (35) et (36) avant de les fixer à l'aile d'un capuchon au dessous.

25

Assembly of right wing
Assemblage de l'aile droite

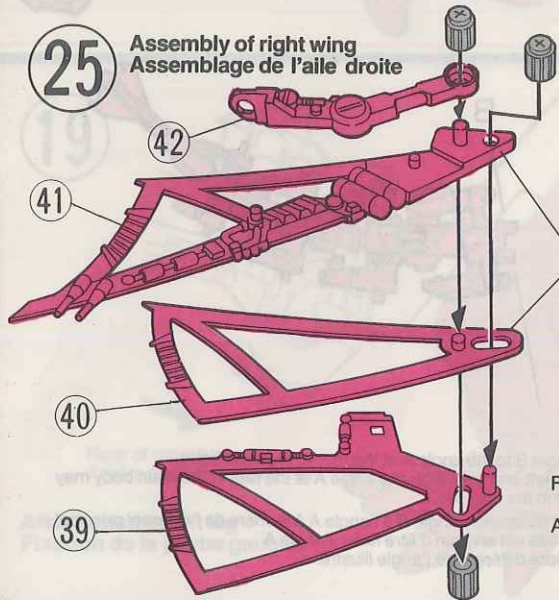
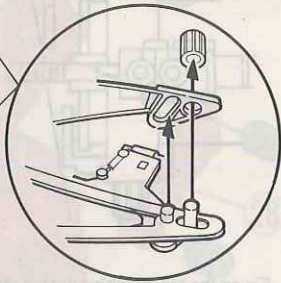

First assemble (39) and (40) then fix with a cap from underneath.
Assembler (39) et (40) avant de les fixer à l'aile d'un capuchon au dessous.

26

How to attach the right wing
Comment attacher l'aile droite

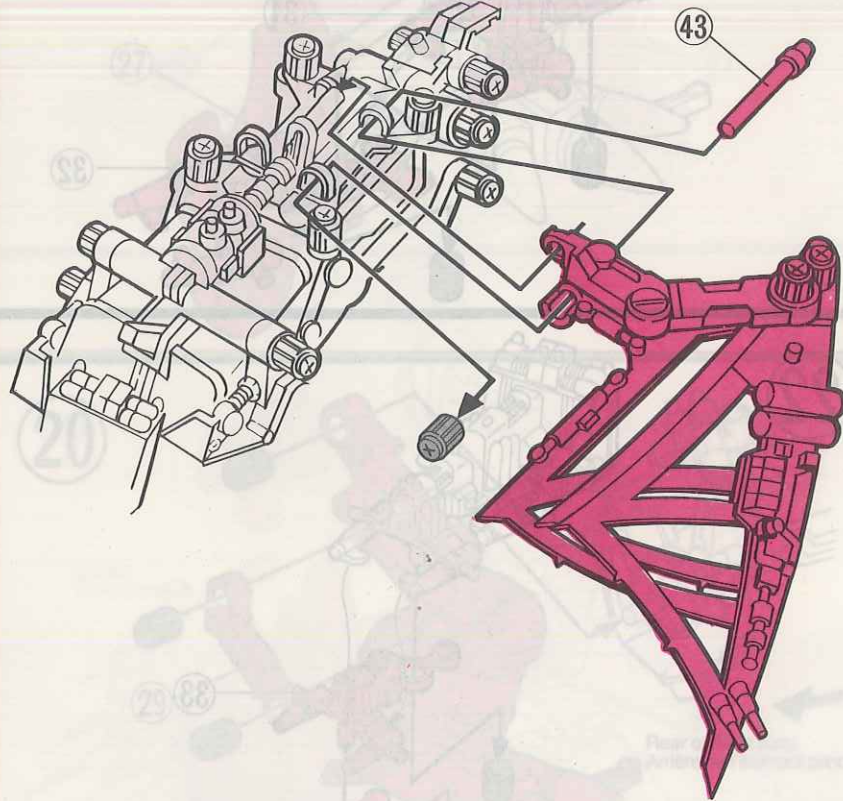

27

How to attach the left wing
Comment attacher l'aile gauche

30

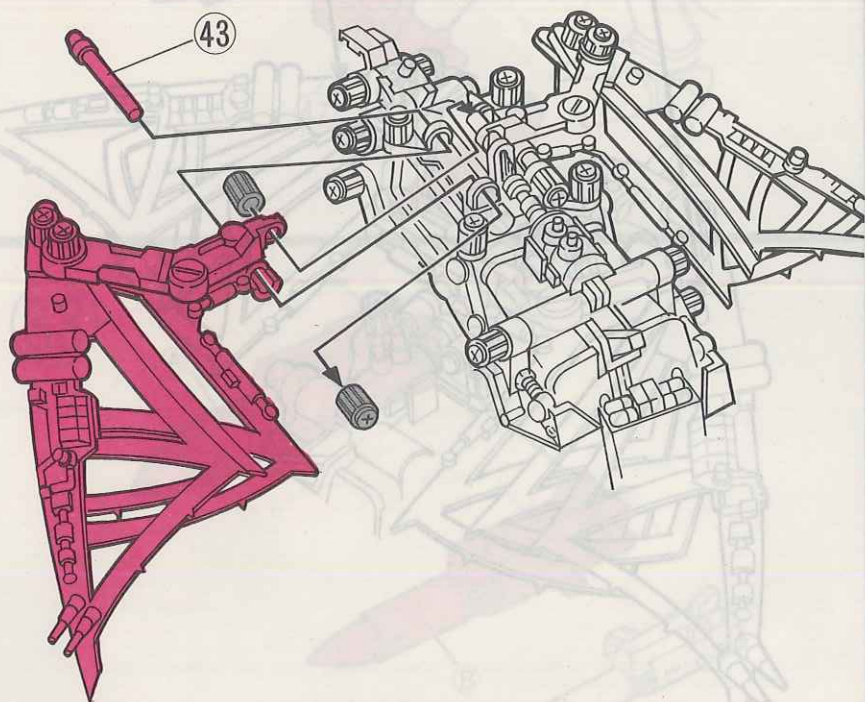

28

32

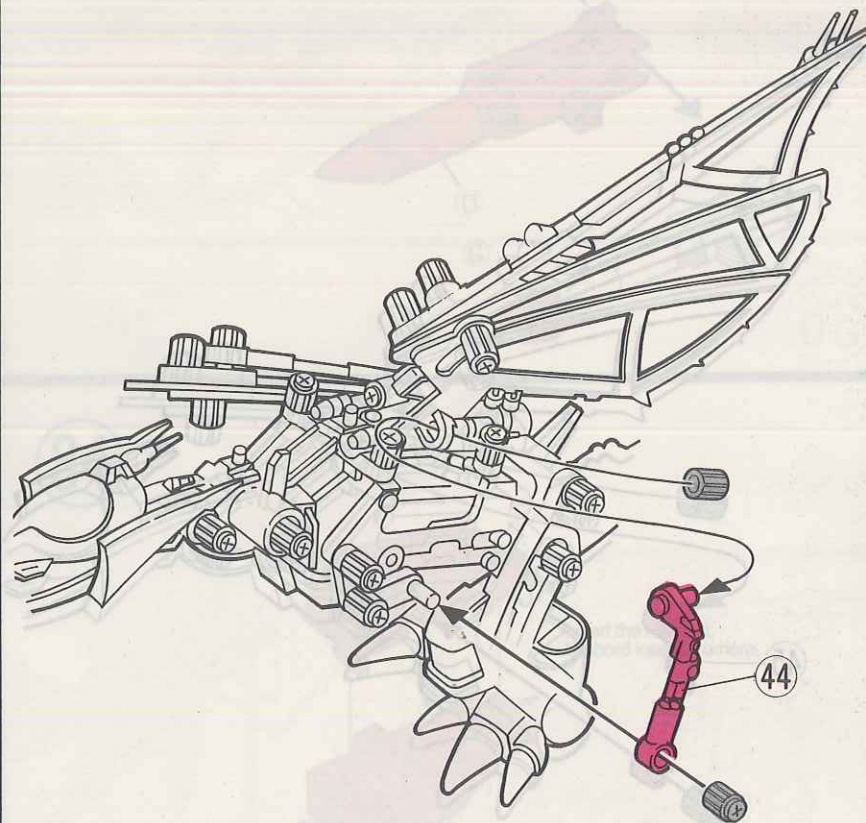

29

How to attach the left wing
Comment attacher l'aile gauche

85

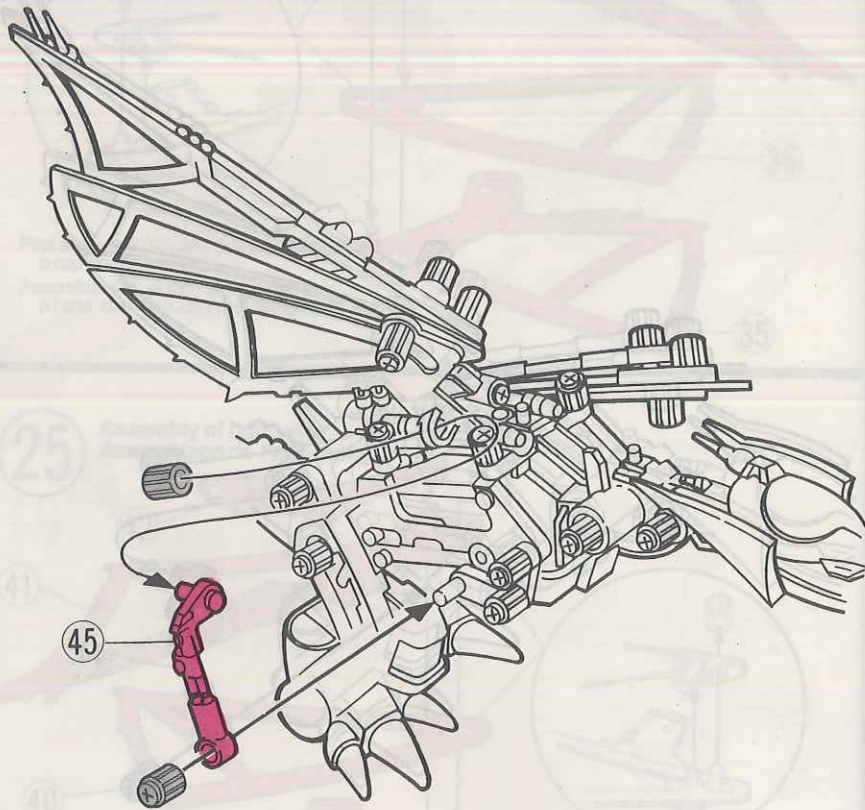

45

Preferably use the same size of screws as the ones used in the previous step.
Préférez utiliser des vis de même taille que celles utilisées dans l'étape précédente.

30

How to attach the right wing
Comment attacher l'aile droite

86

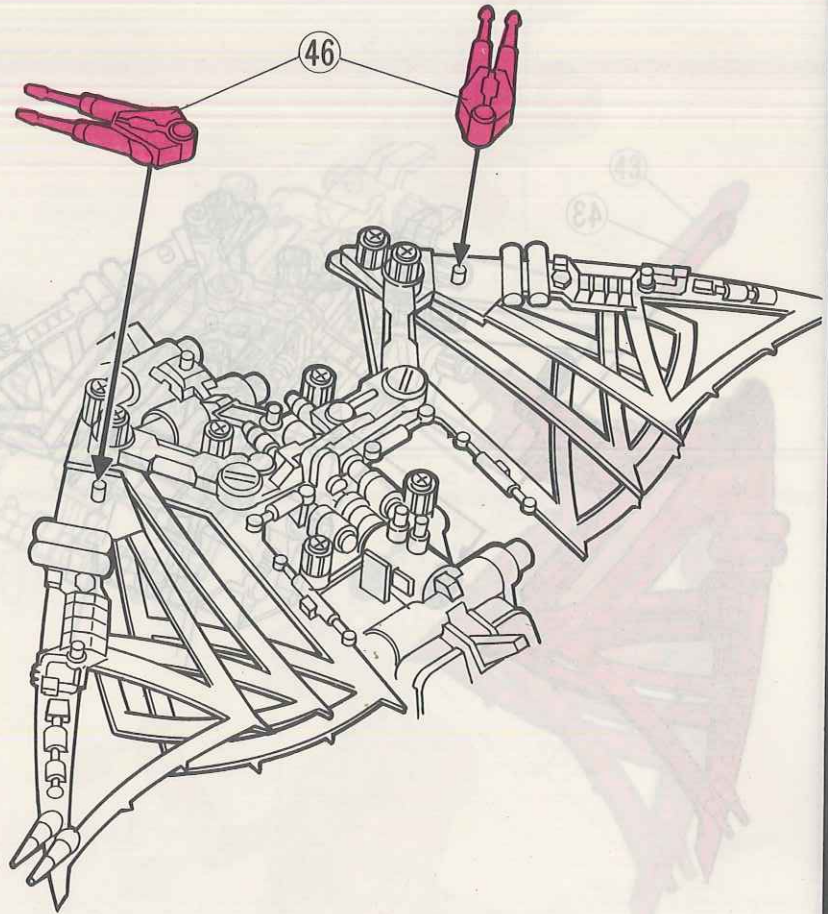

46

31

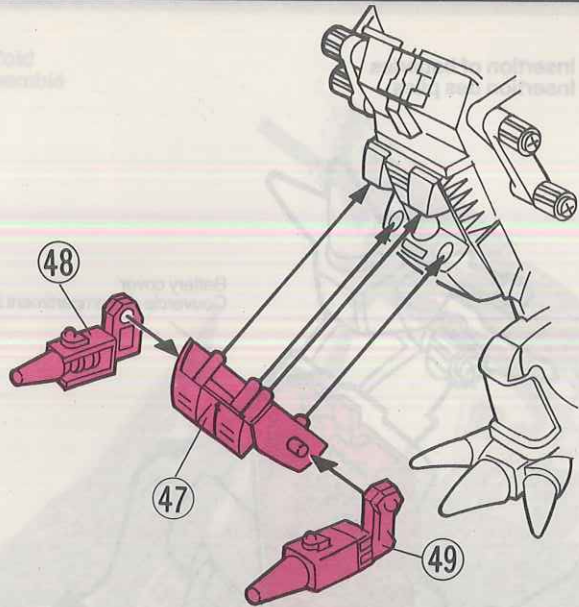

32

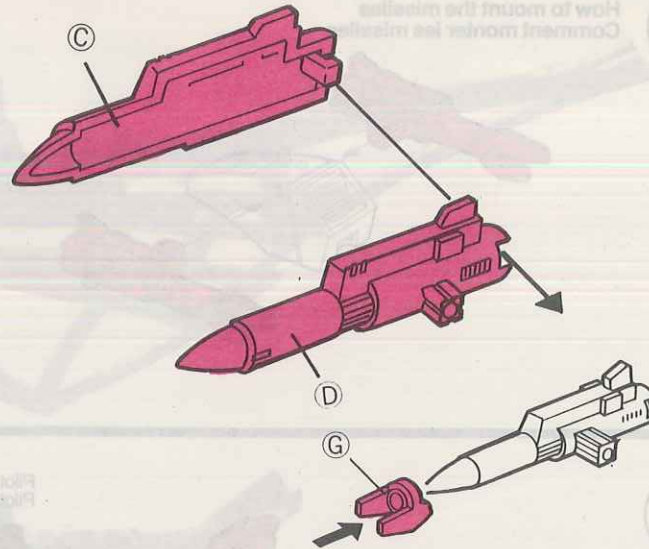

33

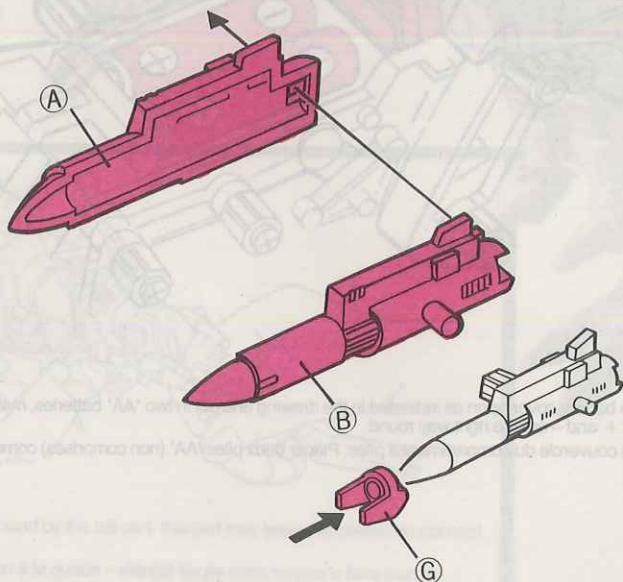

34

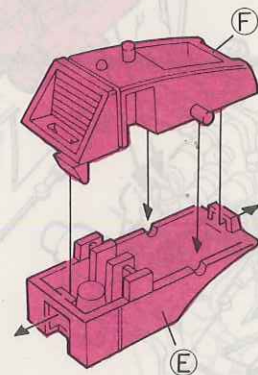

Insert the rear first.
D'abord insérer l'arrière.

35

How to mount the missiles
Comment monter les missiles

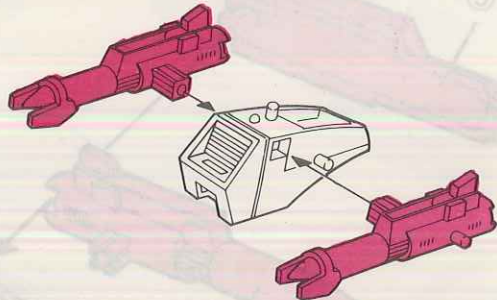

36

Pilot
Pilote

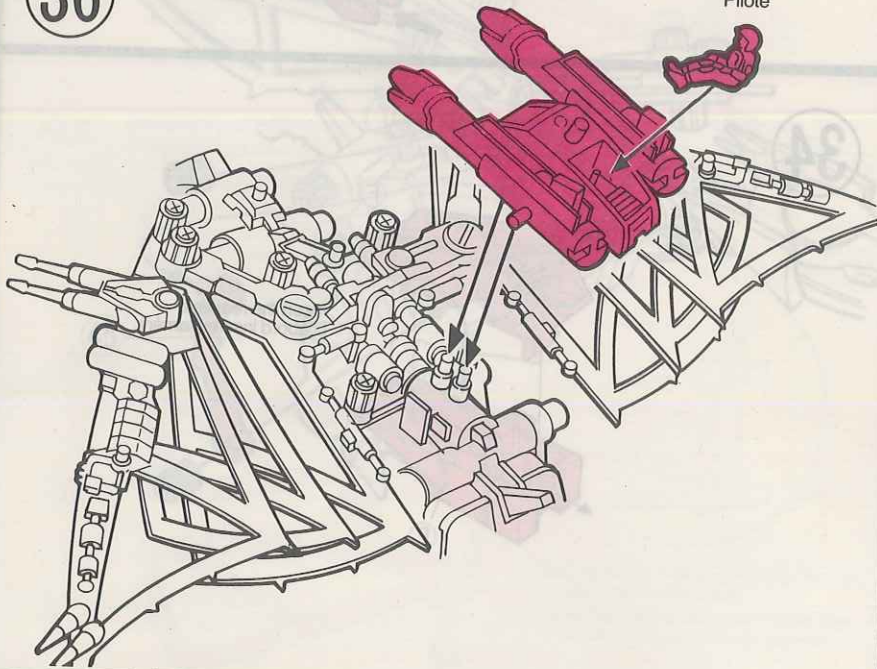

37

Insertion of batteries
Insertion des piles

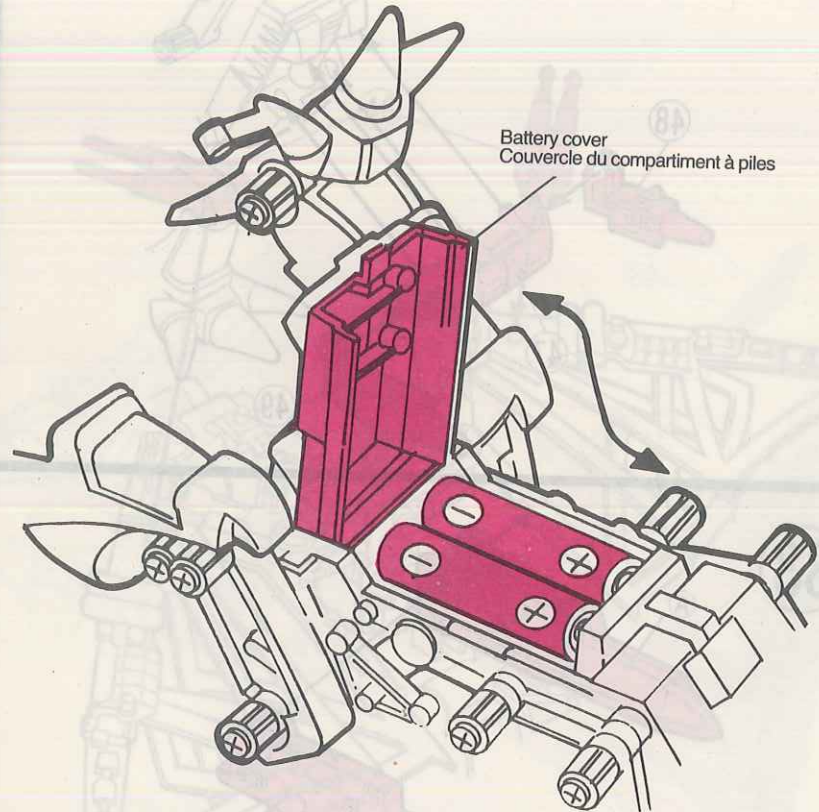

Slide the battery cover open as indicated in the drawing and put in two 'AA' batteries, making sure the + and - are the right way round.
Ouvrir le couvercle du compartiment à piles. Placer deux piles 'AA' (non comprises) comme indiqué.

Completed Zoid
Zoid tout assemblé

Ref No. 5904 KRAPIK

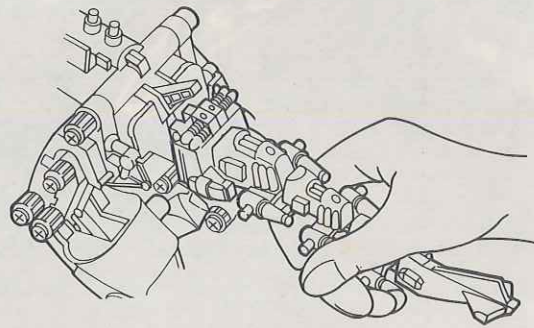
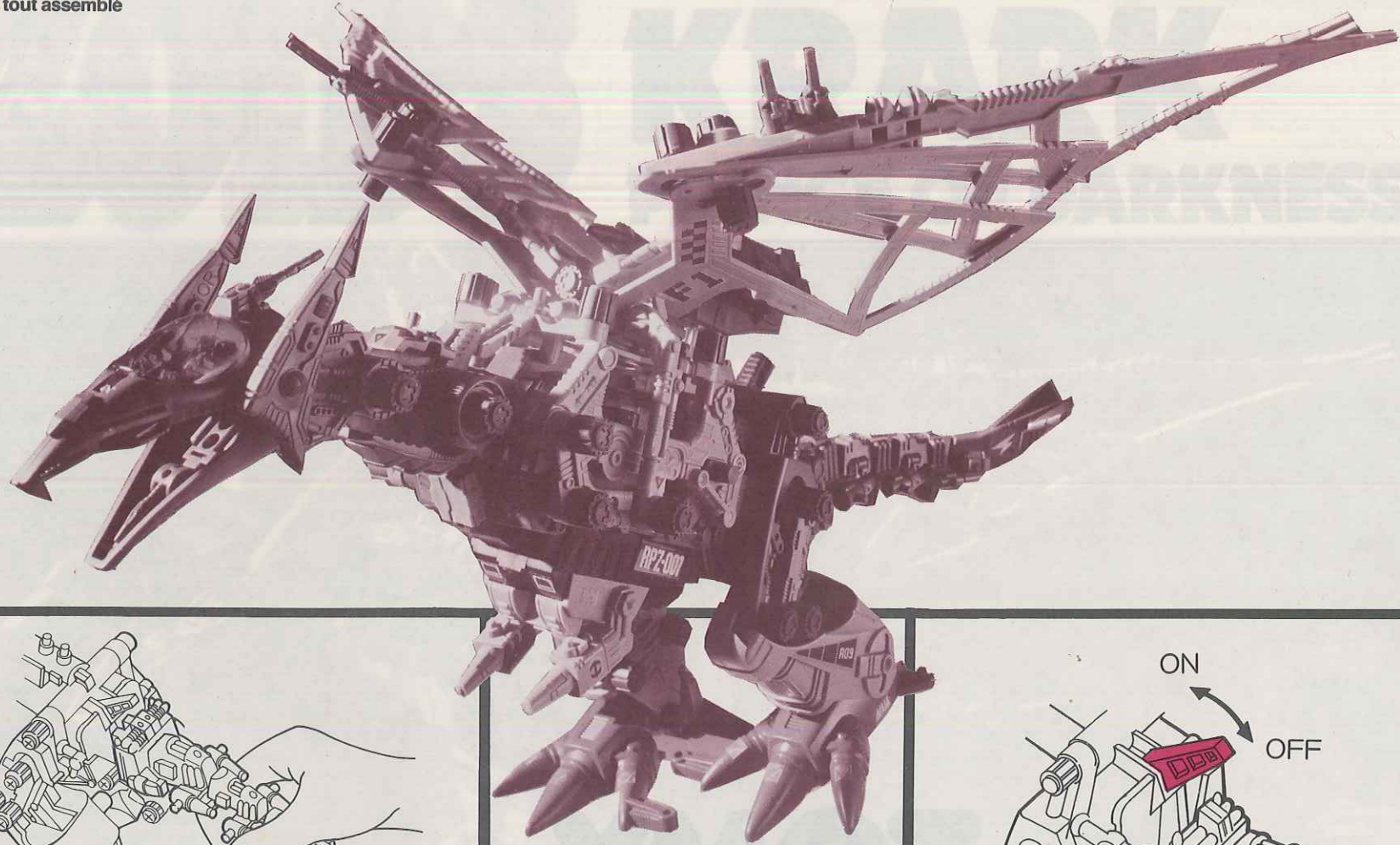

If it is swung round by the tail part, this part may break, so please do not hold the tail.

Faites attention à la queue – elle est fragile donc ne pas le faire tourner par la queue.

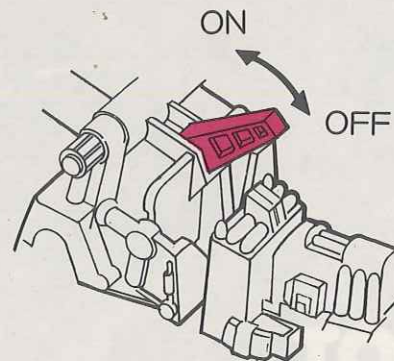

It will start moving when you switch on the switch on top of the main body.
Appuyer sur le bouton ON/OFF sur l'élément principal pour commencer l'action.

35

How to connect the motor
Connect the motor to the battery pack

37

Insertion of battery
Insert the battery into the compartment

Completed Set
Set out assembly

36

TOMY®

PRINTED IN SINGAPORE

