

# ZOIDS

## MIGHTY ZOIDZILLA

Fixer les étiquettes comme  
sur la boîte (photo)  
package (photo)  
N°s indiqués sur la boîte

Rubber  
Caoutchouc

avant d'assembler ces  
pièces, bien enlever tout  
excès de plastique  
après l'assemblage  
Ces pièces sont  
à assembler

Ref No: 5900

TOMY





**BEFORE YOU BEGIN.** Do not cut parts off frame before studying each picture thoroughly. Before cutting, match each part number (located on small tabs on the frame) with the corresponding number in each diagram.

Now starting with step 1, use your safety scissors to cut the part off the frame as needed. Remove excess plastic where part was cut from frame. Continue to put your Zoid together part by part. They snap together and do not require glue. When you're done just turn on the switch to start actions.

**AVANT DE COMMENCER.** Ne pas découper les pièces avant d'avoir bien étudié chaque illustration. Avant de découper, identifier chaque numéro de pièce (situé sur le cadre) avec le numéro correspondant de chaque schéma. Tout d'abord, avec des ciseaux à bouts ronds, découper au fur et à mesure les pièces du cadre. Enlever l'excès de plastique là où la pièce a été coupée du cadre. Assembler le Zoid pièce par pièce. Elles s'emboîtent, pas besoin de colle. Lorsque le Zoid est assemblé, simplement pousser l'interrupteur pour l'actionner.

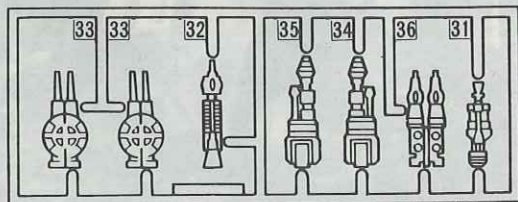
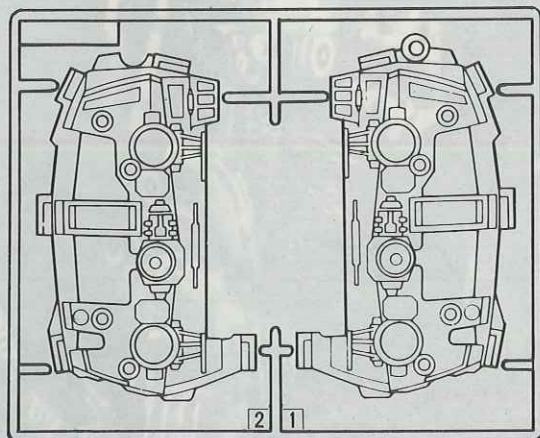

Cap  
Capuchon

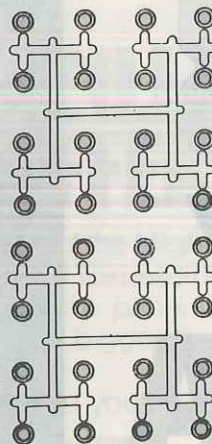

Canopy.  
Pare-brise.



Weight (L).  
Poids (L).



Weight (S).  
Poids (S).



Pilot.  
Pilote.



Battery Box.  
Boîtier Piles.

Lighting Unit.  
Bloc Lumière.

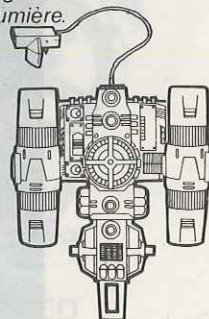

Driving Unit.  
Unité de Pilotage.

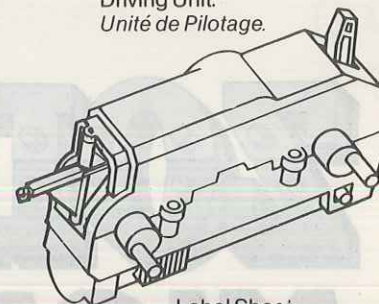

Label Sheet.  
Planche d'étiquettes.

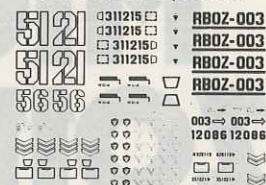

Afix labels as shown on the package (photo).  
Fixer les étiquettes comme sur la boîte (photo)

Tail.  
Queue.

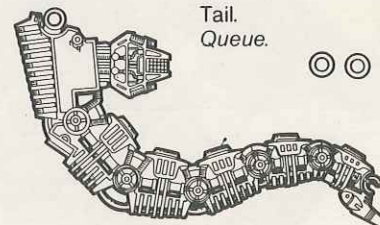

Rubber.  
Caoutchouc.

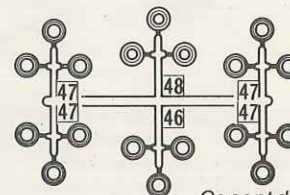

These are moving parts, be sure to remove excess plastic before assembling these parts.

Ce sont des pièces mobiles; avant d'assembler ces éléments, bien enlever tout excès de plastique.



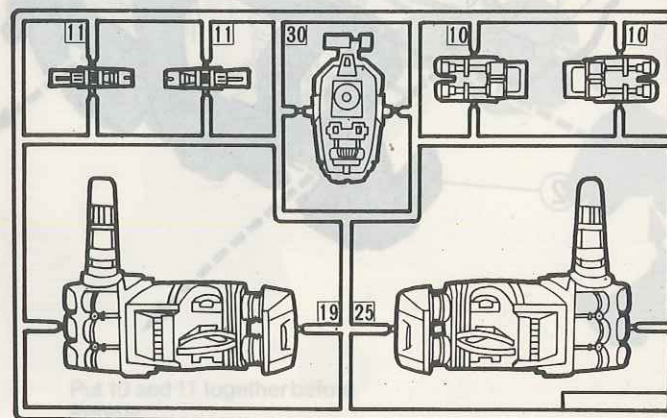
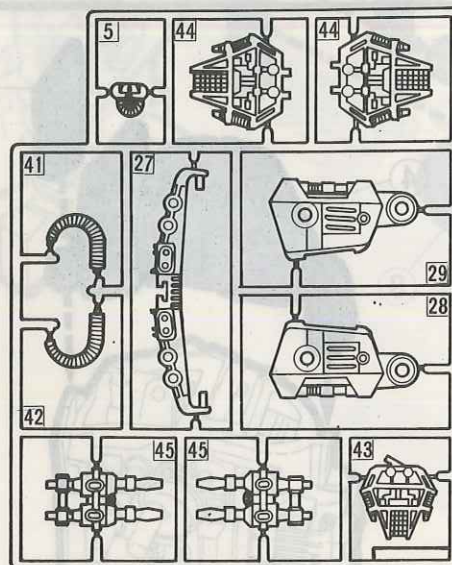
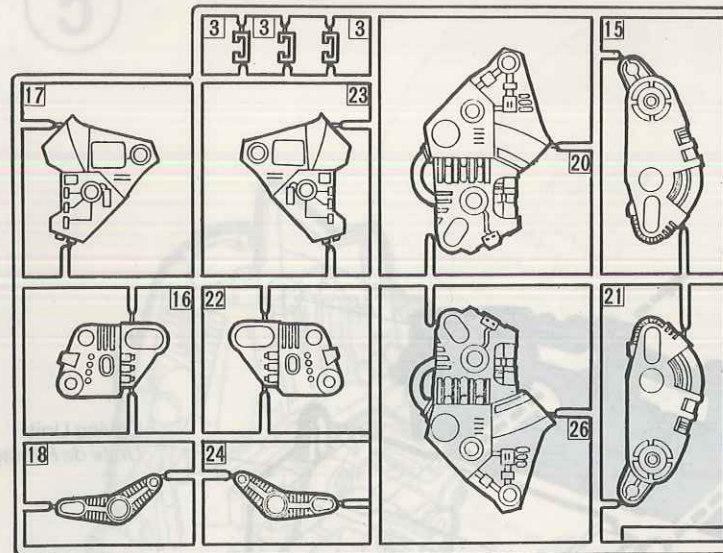
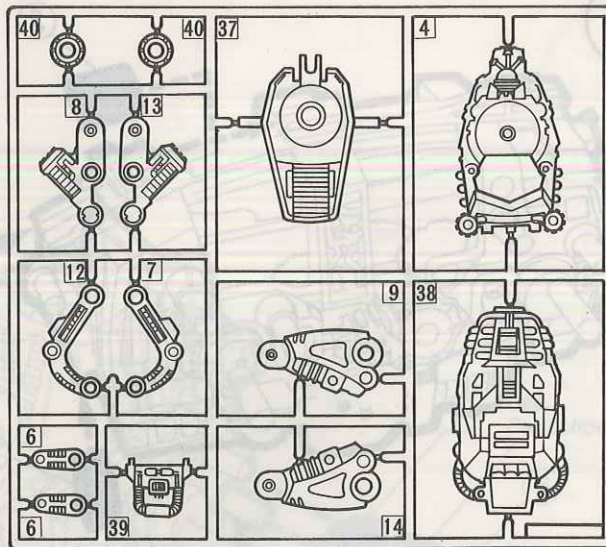

Assemble 12 et 13 avant de  
passer à l'étape 5.



1

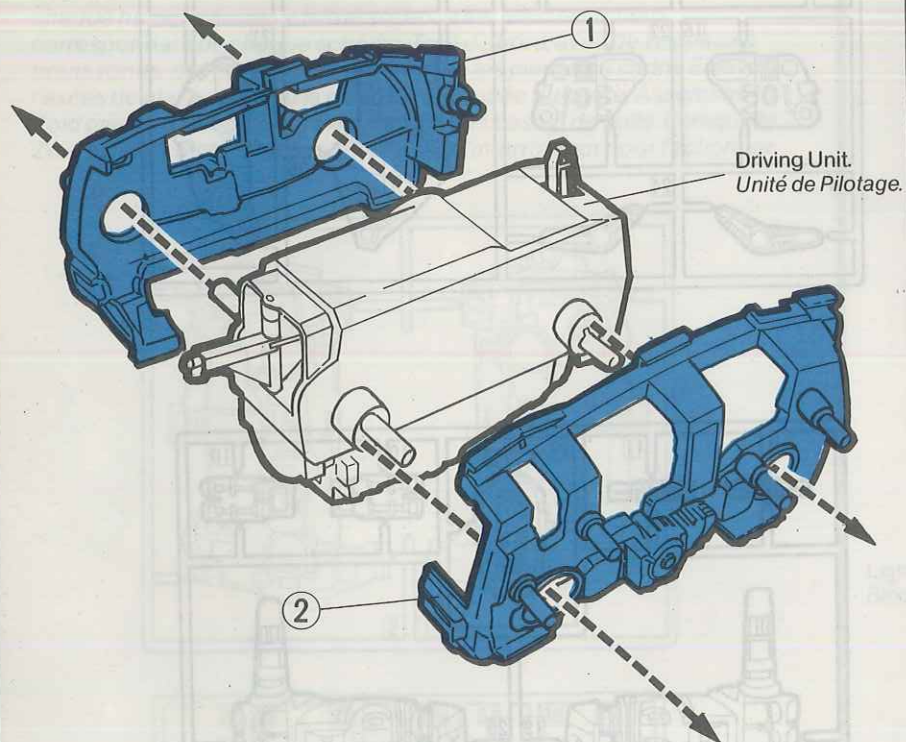

2

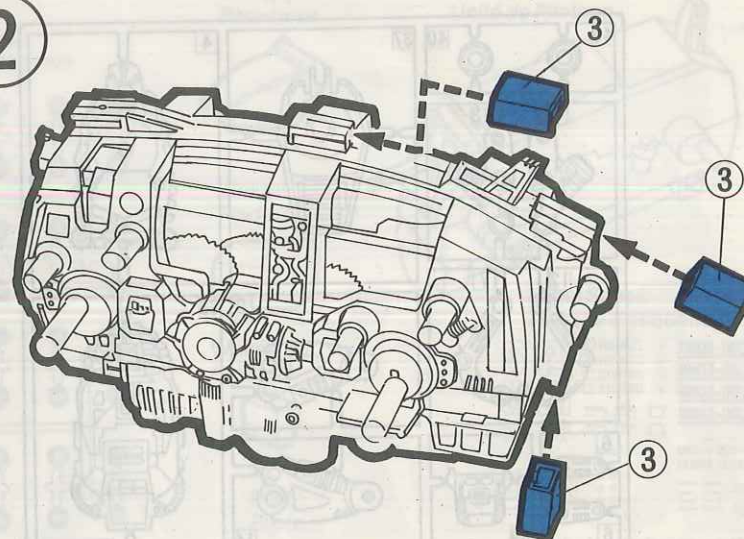

3

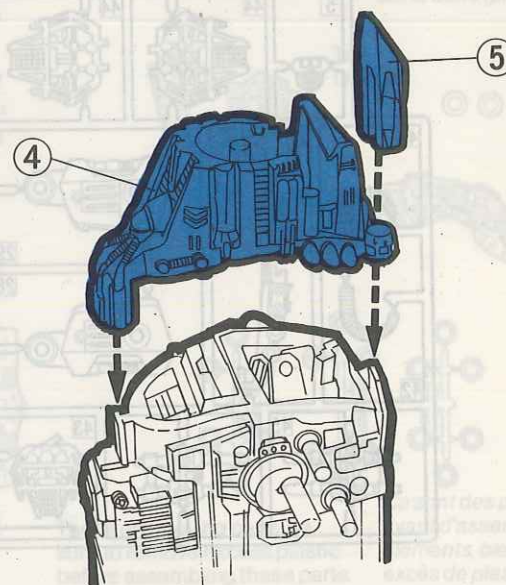



4

LEFT ARM.  
BRAS GAUCHE.

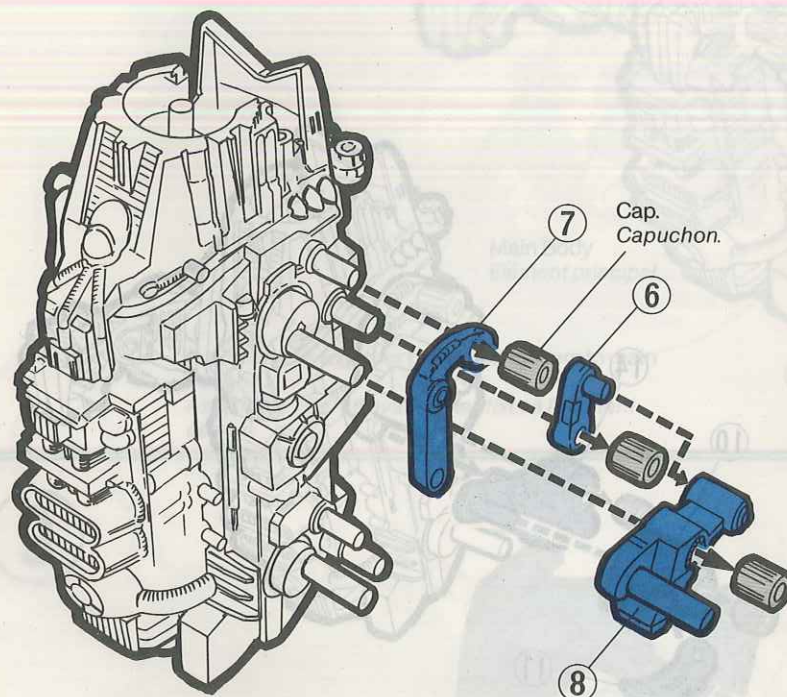

5

LEFT LEG  
JAMBE GAUCHE

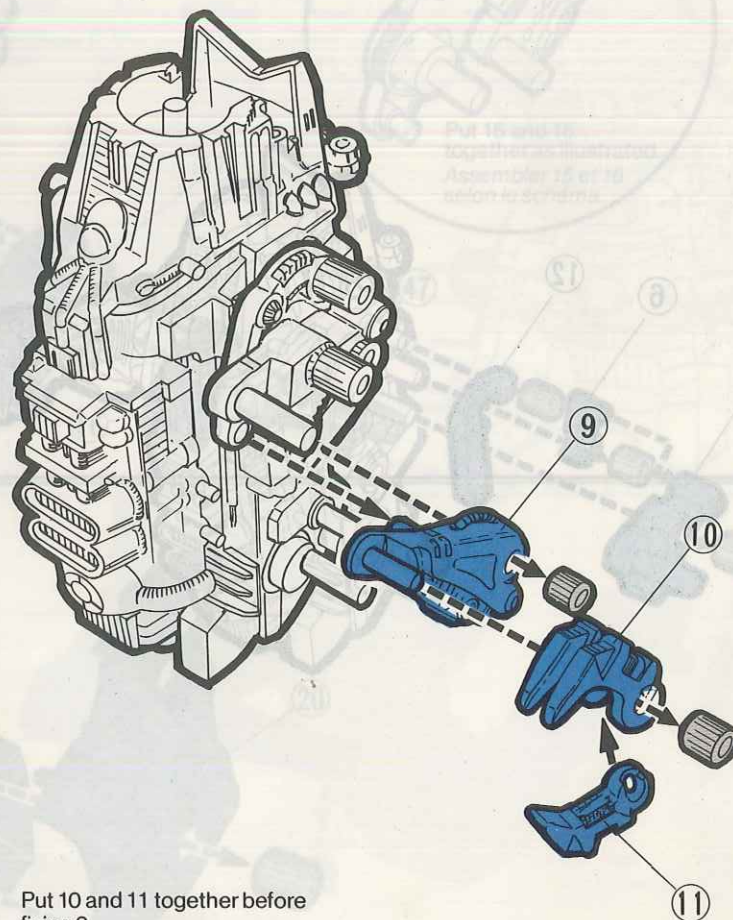

Put 10 and 11 together before  
fixing 9.  
Assembler 10 et 11 avant de  
fixer 9.

6

RIGHT ARM.  
BRAS DROIT.

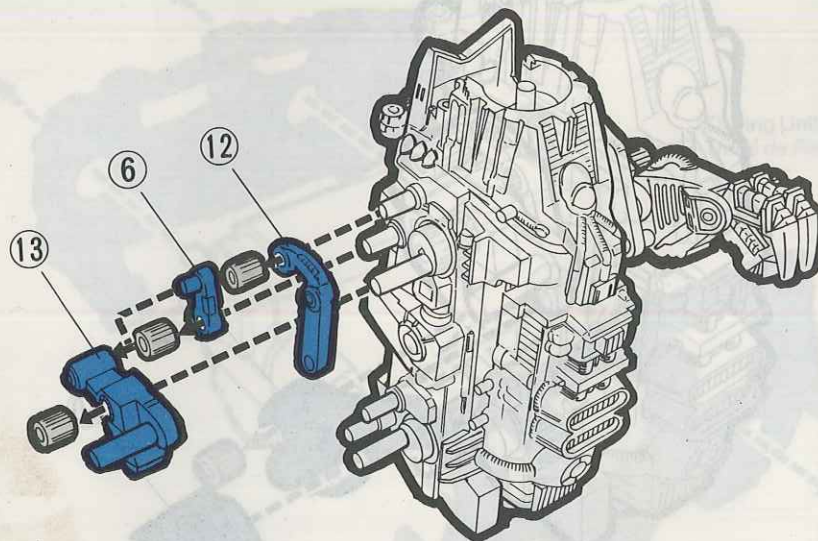

7

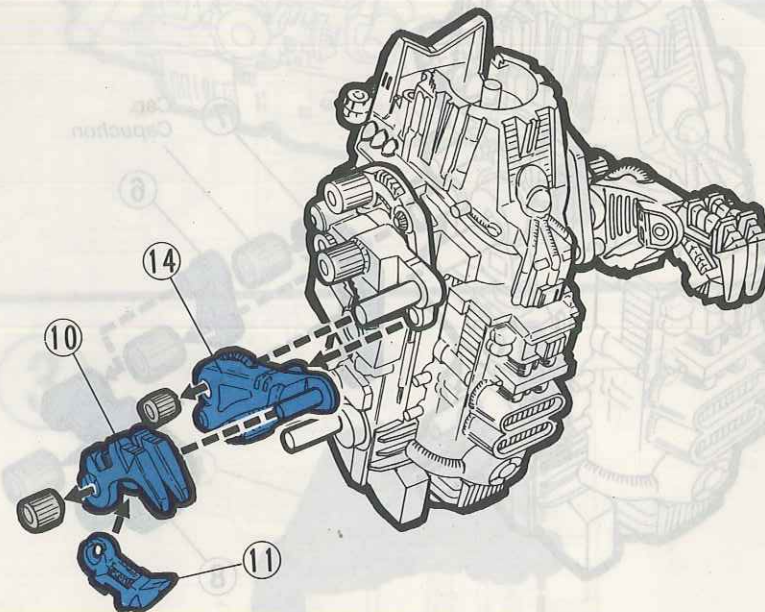

Put 10 and 11 together  
before fixing 14.  
Assembler 10 et 11 avant de  
fixer 14.



8

MAIN BODY  
ÉLÉMENT PRINCIPAL

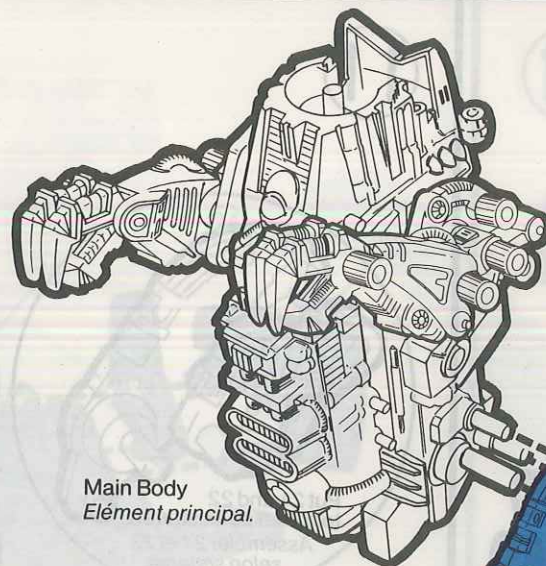

Main Body  
Élément principal.

Put 15 and 16 together before fixing them to main body.  
Assembler 15 et 16 avant de les fixer à l'élément central.

LEFT LEG.  
JAMBE GAUCHE

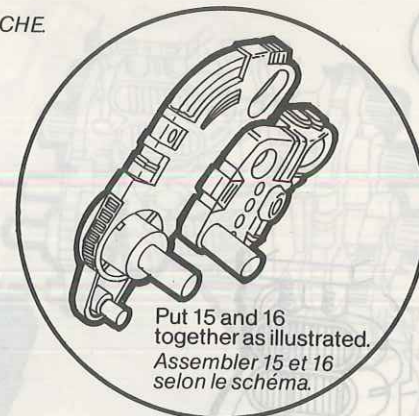

Put 15 and 16 together as illustrated.  
Assembler 15 et 16 selon le schéma.

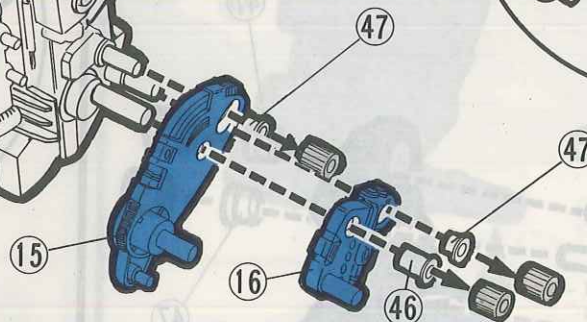

9

Main Body  
Élément principal

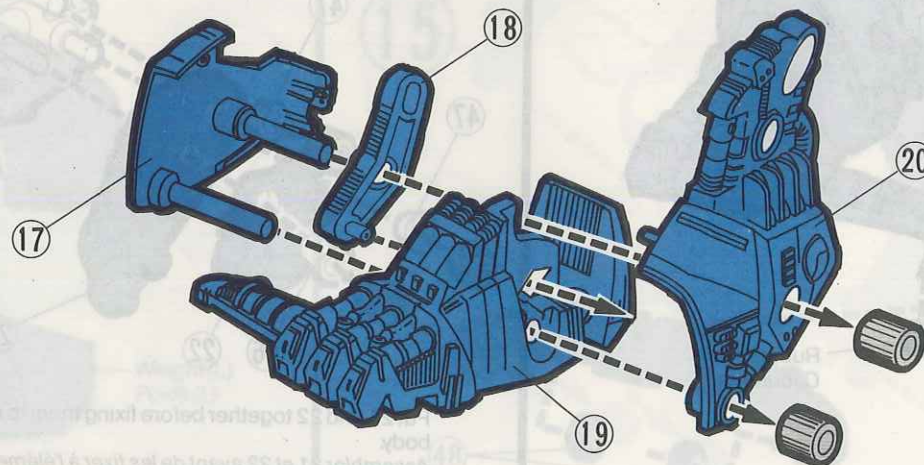

Tail  
Queue



10

LEFT LEG  
JAMBE GAUCHE

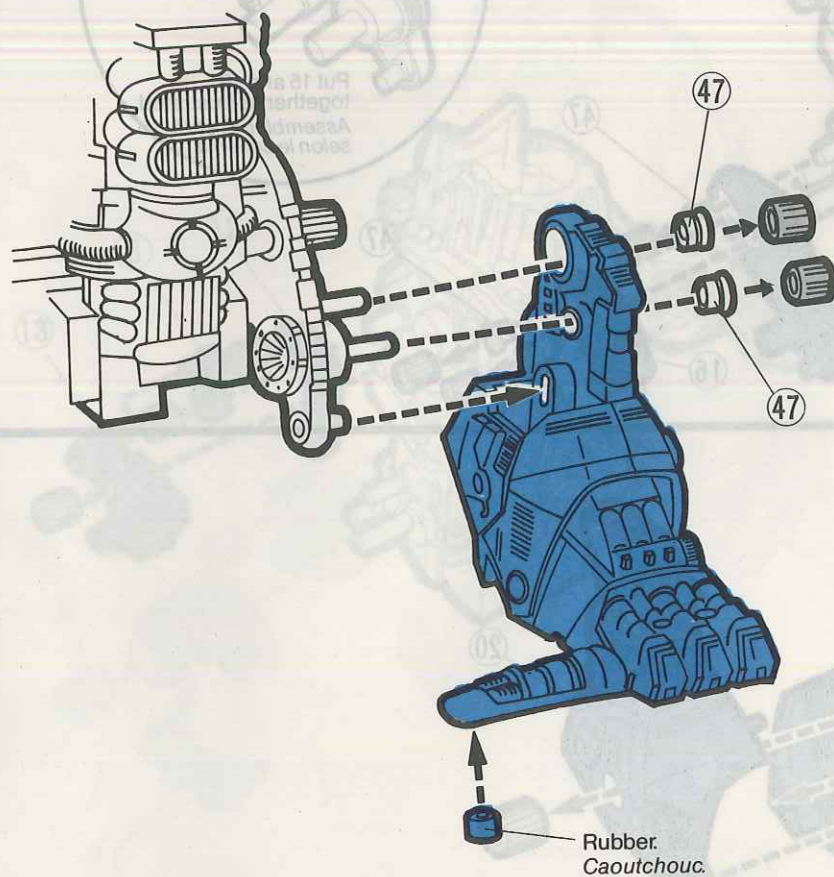

11

RIGHT LEG.  
JAMBE DROITE.

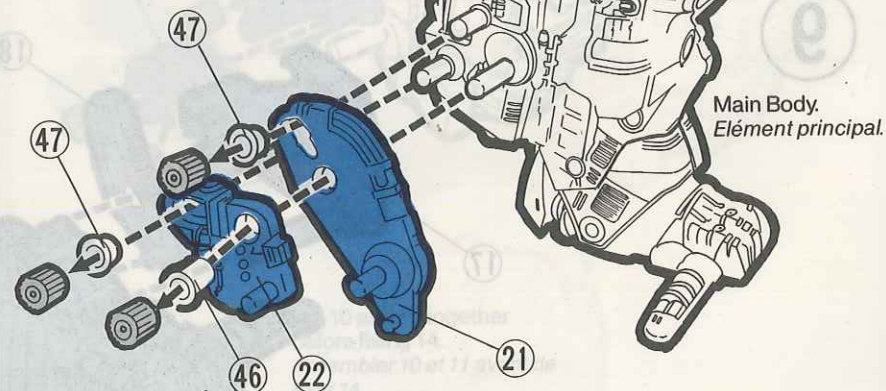
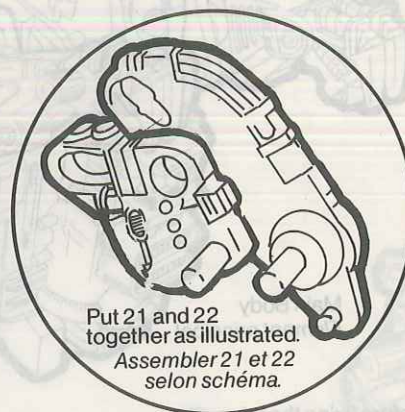

Put 21 and 22 together before fixing them to main  
body.  
Assembler 21 et 22 avant de les fixer à l'élément  
central.



12

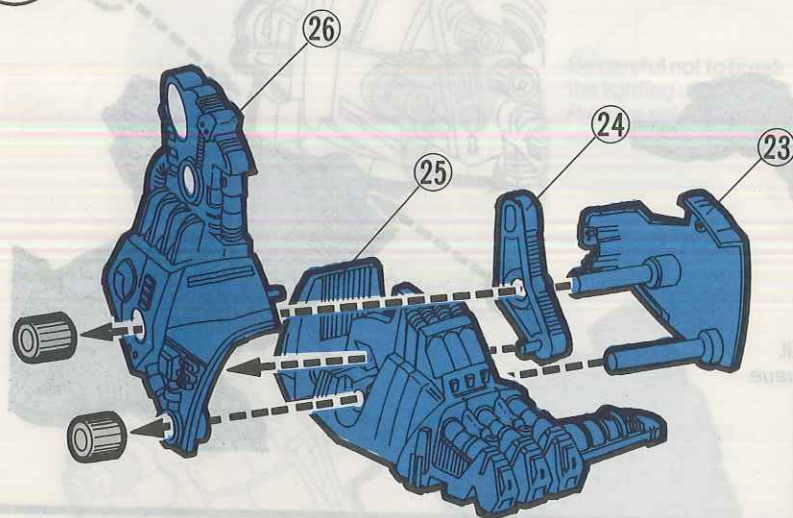

13

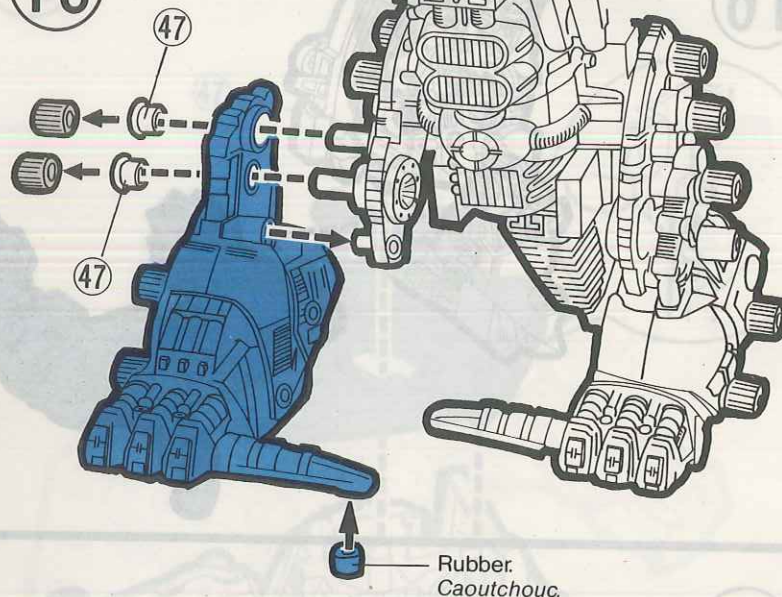

14

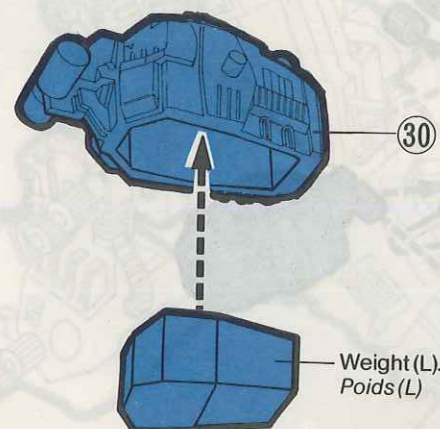

15

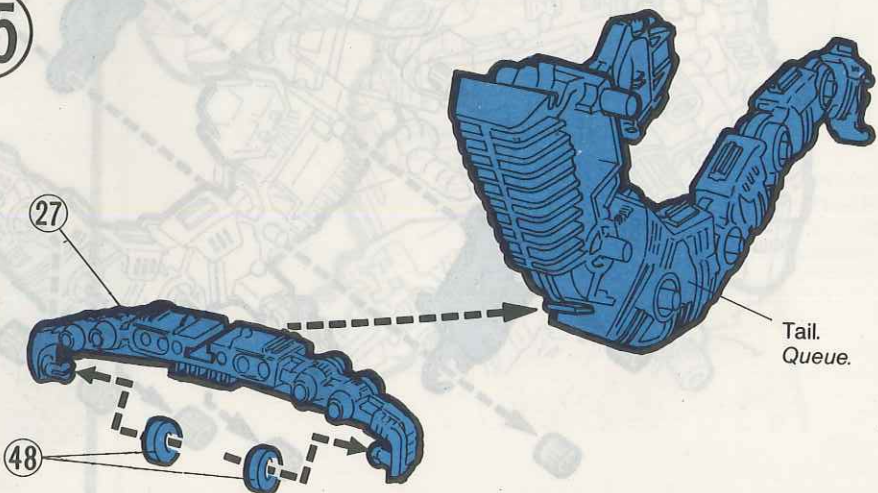



16

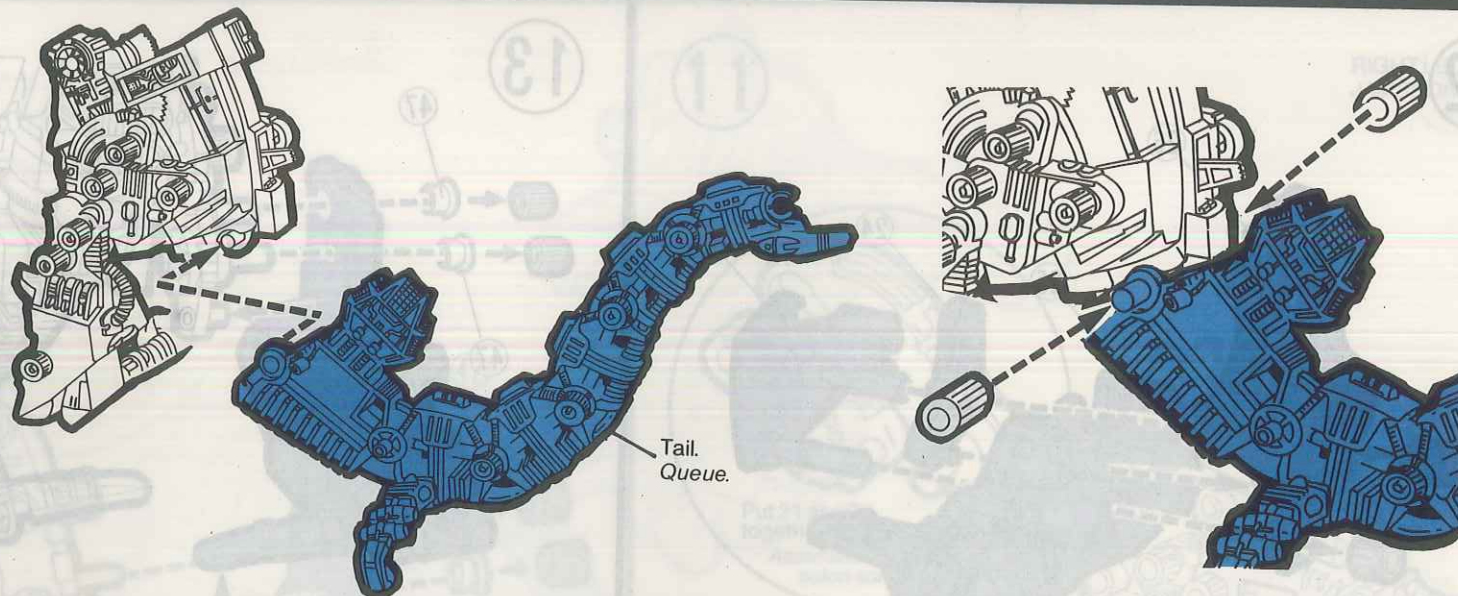

17

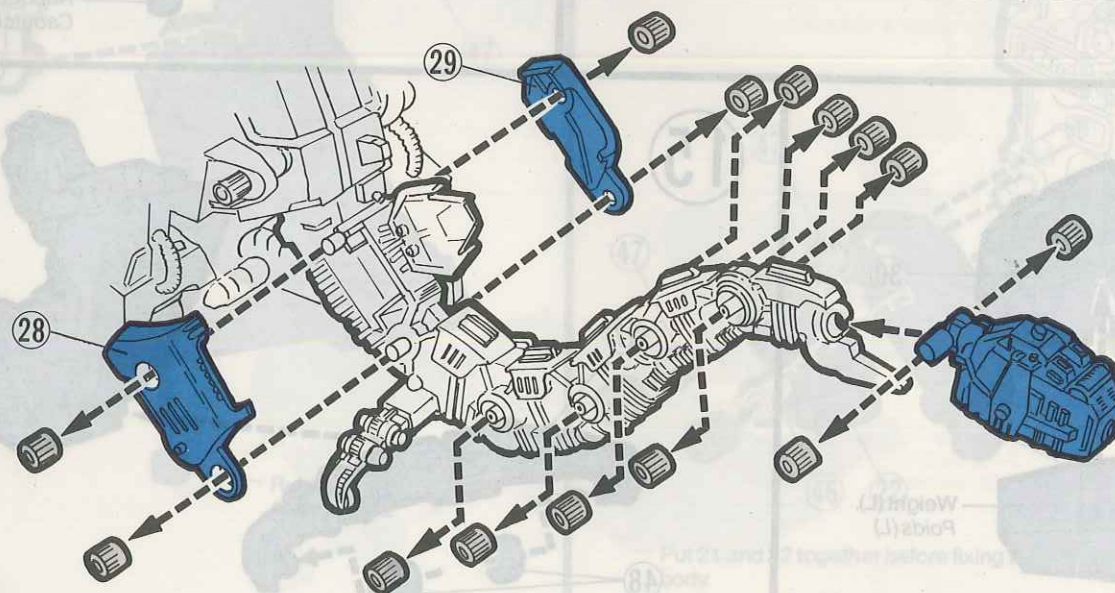



18

Lighting Unit.  
Bloc Limière.

Be careful not to break  
the lighting unit.  
Prendre soin de ne pas  
casser cet élément.

Battery Box.  
Boîtier Piles.

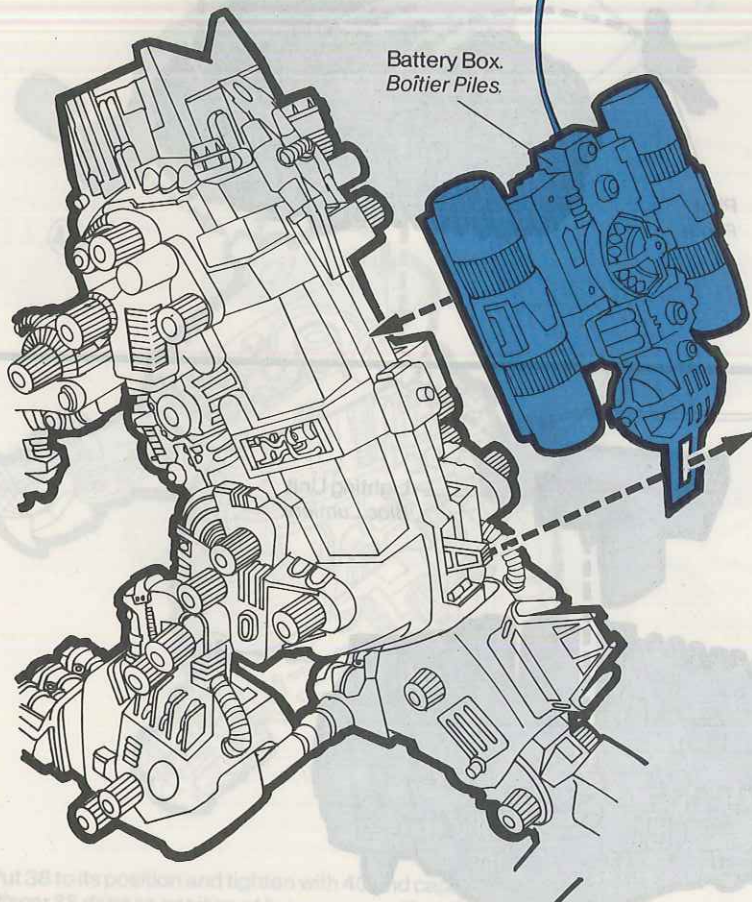

19

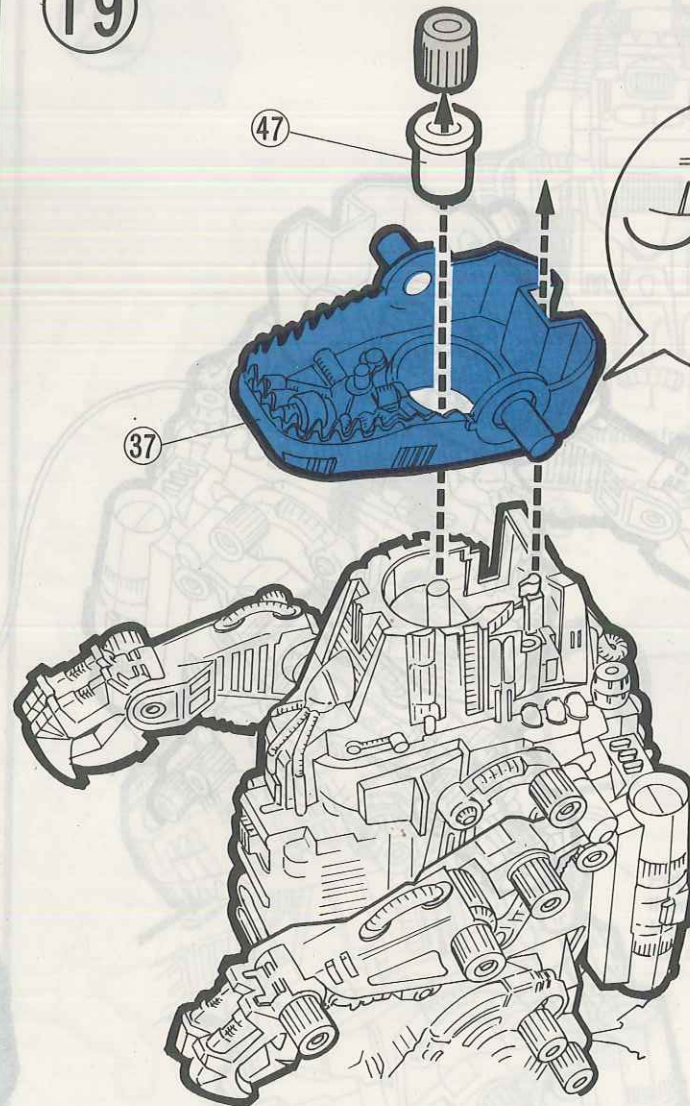



20

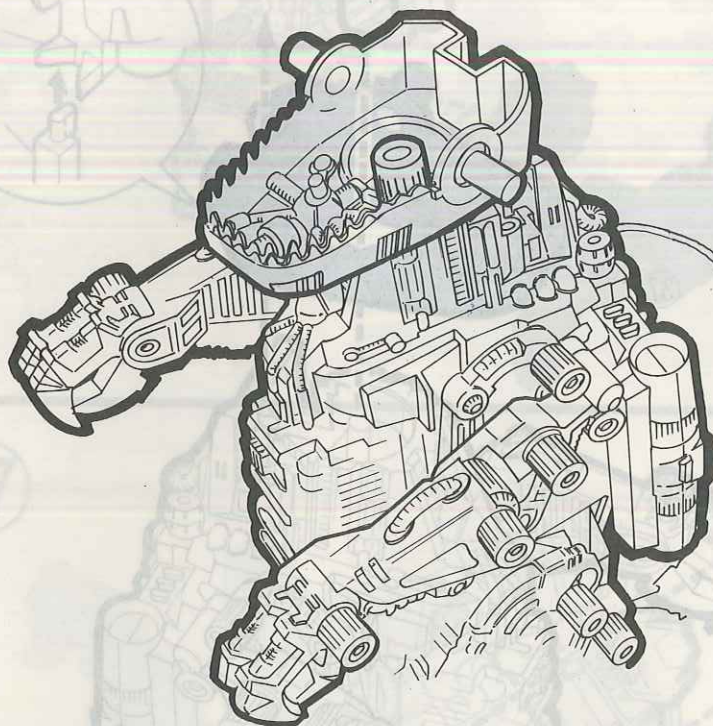

Canopy.  
Pare-brise.

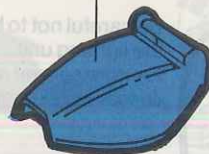

Pilot.  
Pilote.



39



Weight(S).  
Poids(S)

Lighting Unit.  
Bloc Lumière.

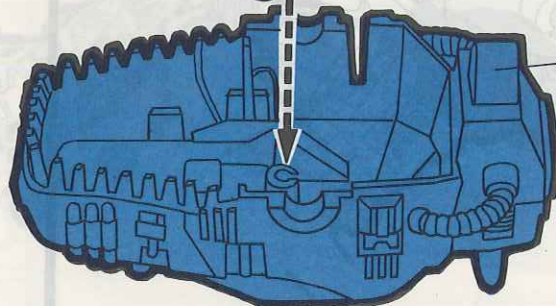

38



21

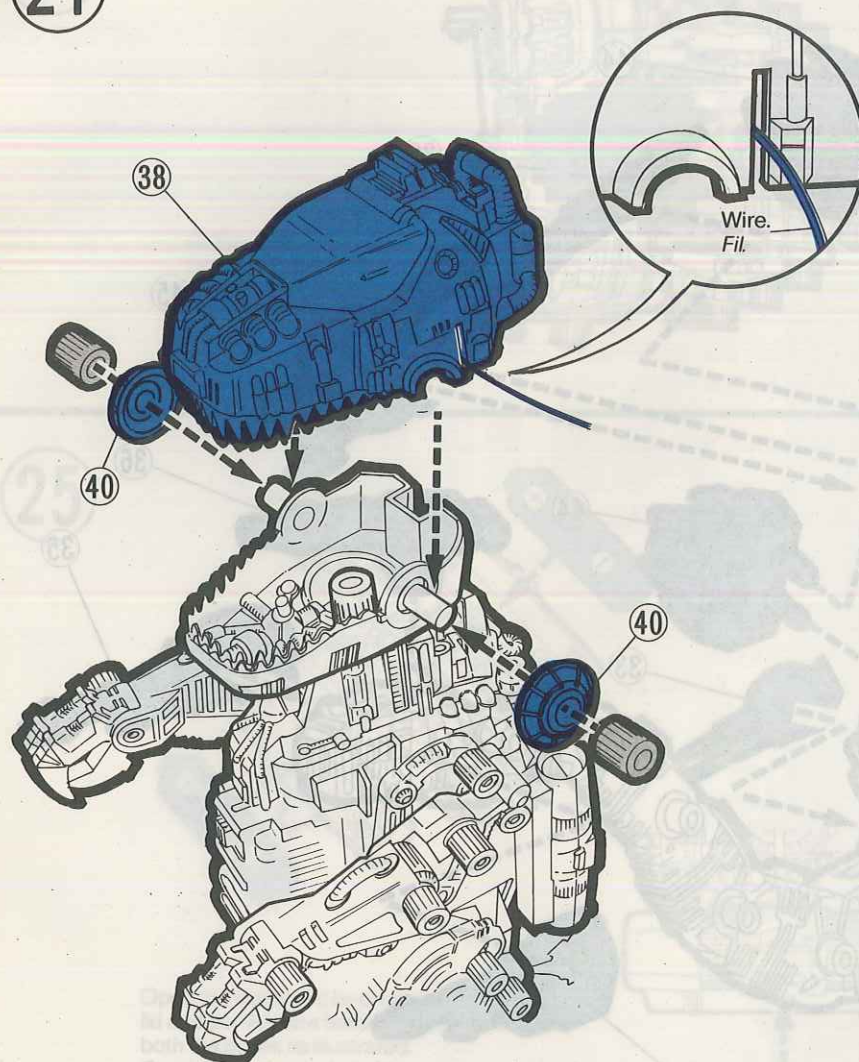

Put 38 to its position and tighten with 40 and caps from both sides.  
Placer 38 dans sa position et le serrer avec 40 et des capuchons des deux côtés.

22

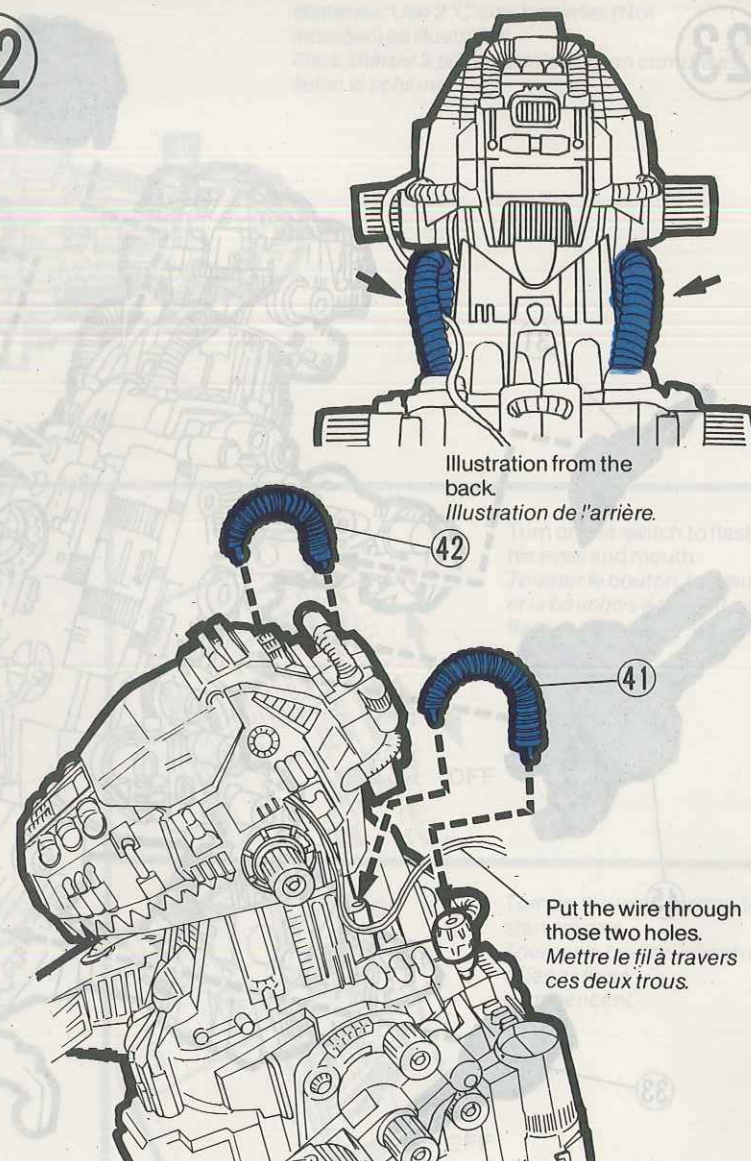



23

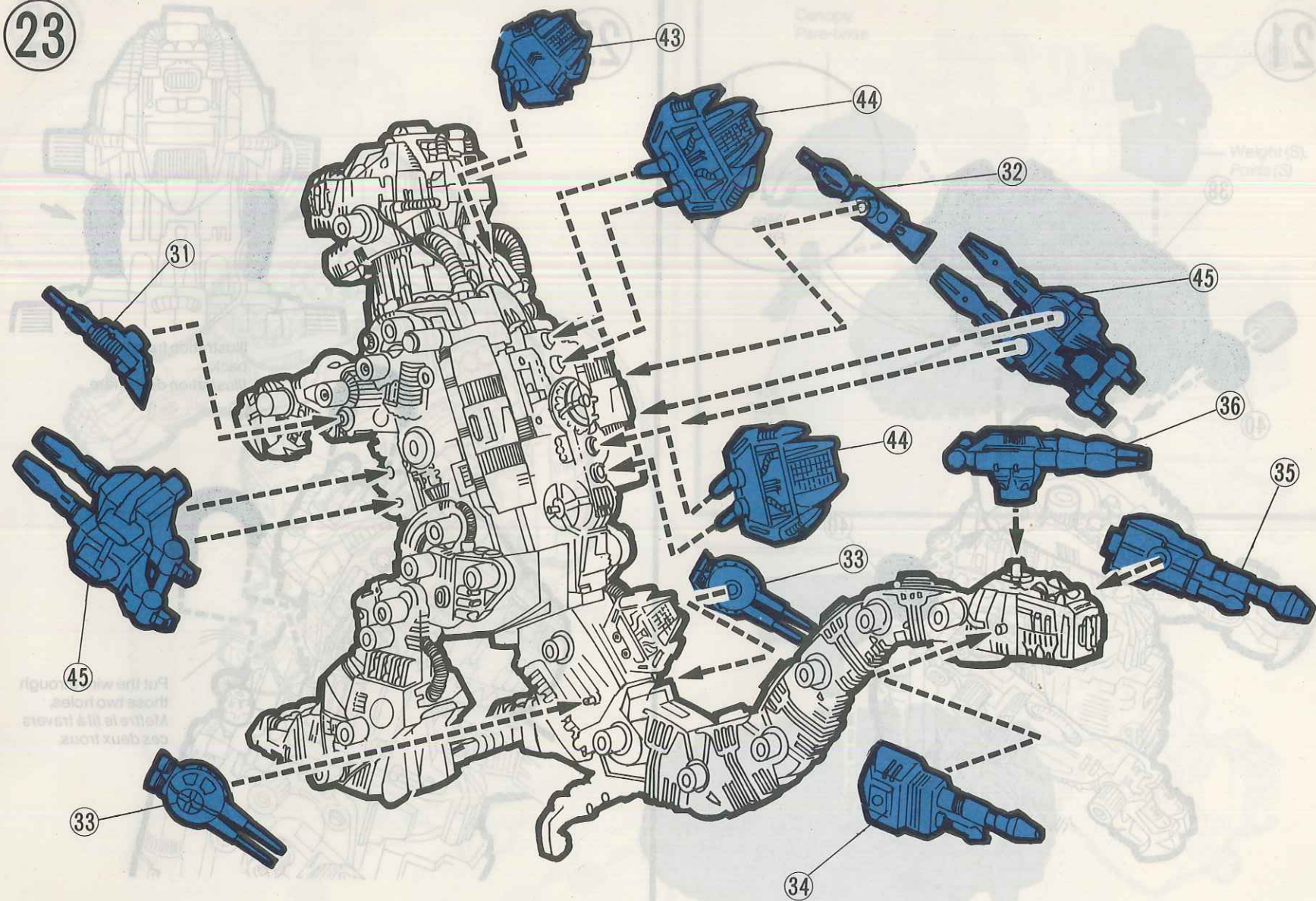

Put 38 in its position and tighten with 40 and cap it on both sides.  
Placer 38 dans sa position et le serrer avec 40 et des capotons aux deux côtés.

Put the wheels on  
those two holes.  
Mettre les roues  
dans ces deux trous.



24

Battery Lid.  
Couvercle des Piles.

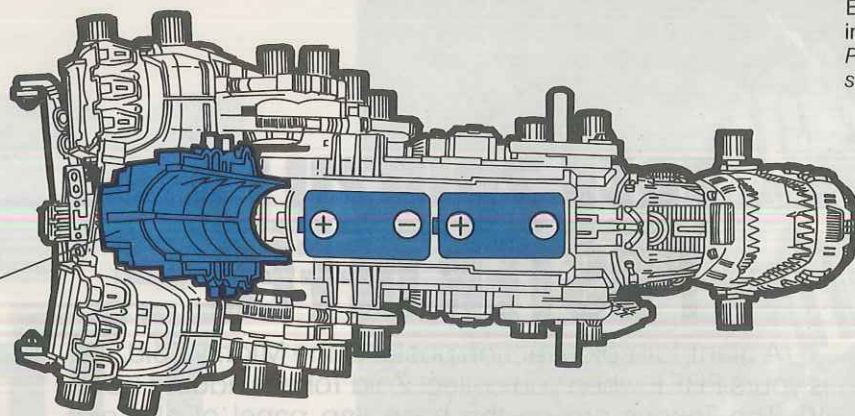

Batteries: Use 2 'C' size batteries (Not included) as illustrated  
Piles: Utiliser 2 piles modèle 'C' (non comprises) selon le schéma.

25

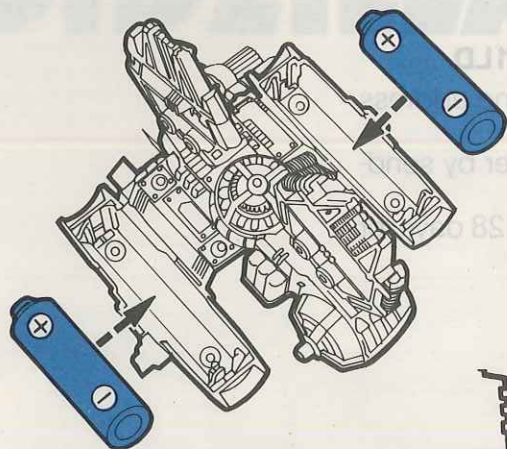

Open the battery lid by pressing the hook of the lid and put 'AA' size battery (not included) into both the boxes as illustrated.  
Ouvrir le couvercle du boîtier en appuyant sur la partie supérieure et insérer des piles 'AA' (non comprises) dans chacune des cases selon schéma.

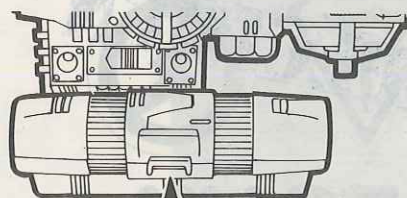

Hook.  
Crochet.

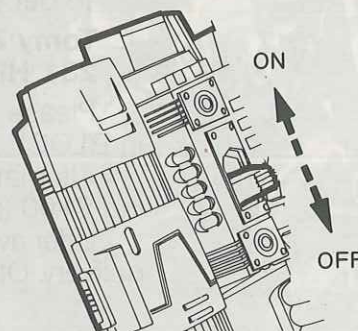

Turn on the switch to flash his eyes and mouth.  
Tourner le bouton, les yeux et la bouche s'éclairent par flash.

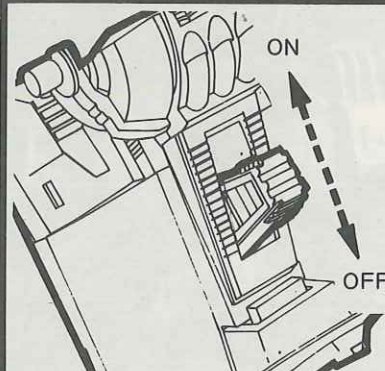

Turn on the lower switch to start actions.  
Tourner le bouton inférieur et les actions commencent.



# FREE ZOIDZILLA POSTER OFFER

A giant, full colour action poster of the Mighty Zoidzilla is yours FREE when you collect Zoid Tokens adding up to 10. The Tokens are on the base flap panel of all Zoid boxes. The bigger the Zoid – the bigger the value of the Token.

To get your Zoidzilla poster send your tokens to:

**Tomy Zoidzilla Offer, Wells House,  
231 High Street, Sutton Surrey, SM1 1LD**

Please remember to include your name and address in BLOCK CAPITALS

Alternatively, you can buy a Zoidzilla poster by sending £1.00 (inc. p.&p.) to the same address.

Offer available to U.K. residents only. Allow 28 days for delivery. Offer closes 31st December 1985.



# TOMY®

TOMY UK LIMITED

Printed in Singapore